



KING COUNTY

1200 King County Courthouse
516 Third Avenue
Seattle, WA 98104

Signature Report

November 9, 2004

Ordinance 15058

Proposed No. 2004-0397.2

Sponsors Lambert

1 AN ORDINANCE creating King County Road
2 Improvement District No. 133 and ordering the
3 improvement of a portion of Northeast 52nd Street from
4 Ames Lake – Carnation Road Northeast to 298th Avenue
5 Northeast, authorizing interim financing, confirming the
6 final assessment roll and levying assessments against the
7 property within the district.

8

9

10 **STATEMENT OF FACTS:**

11 1. Pursuant to King County Motion 12016, a public hearing was held on
12 November 8, 2004, on the petitions of property owners within the
13 proposed district for the formation of a road improvement district to
14 improve certain streets, and pursuant to RCW 36.88.060 and 36.88.090,
15 for the purpose of considering the formation and the assessment roll for
16 King County Road Improvement District No. 133.

- 17 2. Notice of the hearing was duly published and was duly mailed to each
18 property owner pursuant to RCW 36.88.050 and 36.88.090.
- 19 3. A diagram showing the properties specially benefited by the project
20 and the cost and expense to be borne by each lot or building site was
21 considered by the council.
- 22 4. All written and verbal protests were considered.
- 23 5. It is hereby found those petitions, including all additions thereto and
24 withdrawals therefrom made prior to 5:00 p.m. of the business day before
25 the hearing, are sufficient.
- 26 6. The King County council, sitting as a board of equalization for such
27 purpose, considered the assessment roll and all timely filled written
28 objections made to the confirmation thereof.
- 29 7. It is further found that all requirements of RCW 36.88.020, 36.88.060 and
30 36.88.090 and King County Motion 12016 have been satisfied.

31 BE IT ORDAINED BY THE COUNCIL OF KING COUNTY:

32 SECTION 1. There is hereby established, pursuant to chapter 36.88 RCW, a road
33 improvement district in King County to be known and designated as "King County Road
34 Improvement District No. 133" ("RID 133"). The district shall include all the territory
35 within the boundaries shown on Attachment A to this ordinance.

36 SECTION 2. The following described streets, which are wholly within RID 133,
37 shall be improved by clearing, grubbing, grading, drainage, surfacing with asphalt
38 concrete and any such other work as may be incidental thereto, in accordance with the

39 request on the petition, which improvements are referred to in this motion as the
40 "project":

41 Northeast 52nd Street from Ames Lake – Carnation Road Northeast to 298th
42 Avenue Northeast; approximately 5,525 feet in total length.

43 SECTION 3. It is hereby found that the plan for improvement or construction in
44 RID 133 is feasible and that the benefits to be derived therefrom by the property within
45 said district exceed the cost and expense of the formation of the district and the
46 contemplated construction or improvement therein.

47 SECTION 4. Total costs and expenses of accomplishing the project are estimated
48 to be \$922,133.00. Approximately fifty percent of the estimated cost for the
49 improvement will be borne by and assessed against property within the boundary of RID
50 133. The portion of the total costs and expenses to be assessed the properties within RID
51 133 shall not exceed \$461,066.94. King County shall contribute the remaining balance of
52 the costs to construct Northeast 52nd Street. The property owner's share of the costs and
53 expenses shall be assessed \$5,361.24 per parcel, all located within the boundary of RID
54 133.

55 The actual amount of the final assessment against each parcel of property within
56 RID 133 shall include a portion of the actual total of such costs and expenses incurred in
57 completing the project and shall become a lien against each such parcel of land within
58 RID 133, upon confirmation of the assessment roll by the council. The assessments may
59 be paid in full within thirty days following confirmation of the final assessment roll and
60 notification by the finance and business operations, treasury operations. The amount of
61 any assessment or any portion thereof against property in RID 133 not paid within the

62 thirty-day period after notification shall be paid in five annual and consecutive
63 installments, together with interest on the diminishing principal balance of such
64 assessment which will be set at one-half of one percent higher than the net effective
65 interest rate on the loan obtained to pay the costs of the improvements on RID 133.

66 Interest shall commence on the thirtieth day following first publication of the
67 finance and business operations notice described in section 8 of this ordinance and the
68 first installment shall be due one year from the date.

69 Interest on the assessment amount due shall be based on the interest bearing
70 warrant rate established by the county's service bank, currently eighty percent of the
71 bank's prime borrowing rate, at the time of confirmation of the final assessment roll.
72 Interest will be added annually to the assessed amount due, beginning from the end of the
73 thirty-day prepay period. The estimated net effective interest rate plus one-half of one
74 percent is estimated at seven percent.

75 Following expiration of thirty days after the first publication, the principal balance
76 of the assessment, together with accrued interest and penalty, if any, may be prepaid only
77 at the times and in the manner determined by the King County finance and business
78 operations, treasury operations. Any prepayment made on any date other than an
79 installment due date shall be accompanied by interest on the amount prepaid to and
80 including the date of maturity of the installment next falling due.

81 Any installment that is not paid when due is therefore delinquent. Thereafter,
82 such delinquent installment shall be subject, at the time of delinquency, to a charge of ten
83 percent penalty levied on both principal and interest due upon that installment, and all
84 delinquent installments also shall be charged interest at the rate as determined above.

85 The collection of such delinquent installments shall be enforced in the manner provided
86 by law. The amount of the final assessment, together with interest and provisions for
87 penalty, shall, upon confirmation of the assessment roll by the council, become a lien
88 upon each lot or building site within RID 133 from the time the assessment roll is placed
89 in the hands of the finance and business operations, treasury operations, for collection.

90 SECTION 5. The council, sitting as a board of equalization and having made all
91 revisions to the assessment roll it deems necessary, hereby finds that the assessment roll
92 for RID 133 is just and equitable and that no assessment against any property within RID
93 133 is greater than the special benefits to be derived from the improvement made to such
94 property. Accordingly, the assessment roll, totaling \$461,066.94, is hereby confirmed
95 and the assessments set forth therein are hereby levied against each parcel of property
96 described in the roll.

97 SECTION 6. The manager of the road services division, department of
98 transportation is hereby authorized and directed to contract with the necessary parties for
99 the design and construction of the project.

100 SECTION 7. The clerk of the council is hereby directed to place said RID 133
101 assessment roll, bearing such revisions as the council has made thereto, in the hands of
102 the King County finance and business operations for collection. Upon such placement,
103 the amount of each assessment set forth therein, together with any interest accrued from
104 time to time thereon and any penalty imposed from time to time thereon, will become a
105 lien against the property so assessed. The lien shall be paramount and superior to any
106 other lien or encumbrance whatsoever, theretofore and thereafter created, except for a
107 lien for general taxes.

108 SECTION 8. There is hereby created on the books of the King County finance
109 and business operations one fund of the county, to be designated as the "King County
110 Road Improvement District No. 133 enhanced RID (ERID) fund."
111 Upon receipt of the RID 133 assessment roll, the King County finance and business
112 operations is hereby directed to publish notice at the times and in the manner required by
113 RCW 36.88.270, stating that such assessments or any portion thereof may be paid
114 without interest in the days following first publication of such notice. All moneys
115 collected by the finance and business operations upon any assessment levied on property
116 within RID 133 for the completion of the project during the thirty-day period allowed for
117 payment of such assessment without penalty or interest and all such moneys collected
118 thereafter shall be placed in the said ERID fund. The ERID fund shall be used for the
119 payment of costs and expenses of accomplishing the project and the payment of the
120 principal or interest on the balance drawn upon or issued against the loan. Moneys in
121 said ERID fund shall be used solely to pay principal, and interest on the loan. Upon
122 repayment of the loan, the balance of the RID 133 ERID fund shall be placed in the King
123 County RID/LID participation fund 0386 "Project - RDCW15."

124 SECTION 9. "Costs and expenses of accomplishing the project," as used in this
125 ordinance and in any subsequent ordinance relating to RID 133, shall mean those costs
126 and expenses described in RCW 36.88.300, as follows:

127 A. The cost of all of the construction or improvement authorized in RID 133,
128 including that portion of the construction or improvement within the limits of any street
129 or road intersection, space, or spaces;

130 B. The costs and expense of all engineering and surveying necessary to be done
131 by the county engineer or under his direction or by such other engineer as may be
132 employed by the King County council; and

133 C. The cost of legal service and any other expense incurred by King County for
134 RID 133 or in the formation thereof, or by said district in connection with such .

135 construction of improvement and in the financing thereof, including the issuance of
136 interim financing and long-term financing.
137

Ordinance 15058 was introduced on 8/30/2004 and passed as amended by the Metropolitan King County Council on 11/8/2004, by the following vote:

Yes: 11 - Mr. Phillips, Ms. Edmonds, Mr. von Reichbauer, Ms. Lambert, Mr. Pelz, Mr. Ferguson, Mr. Gossett, Ms. Hague, Mr. Irons, Ms. Patterson and Mr. Constantine
No: 0
Excused: 2 - Mr. McKenna and Mr. Hammond

KING COUNTY COUNCIL
KING COUNTY, WASHINGTON

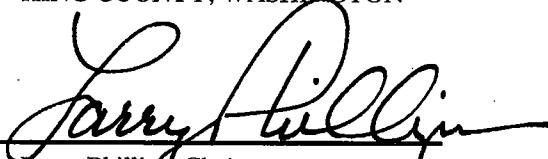

Larry Phillips, Chair

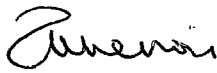
ATTEST:

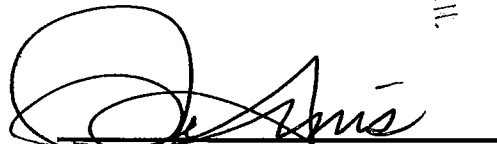

Anne Noris, Clerk of the Council

APPROVED this 19 day of November, 2004.

Ron Sims, County Executive

RECEIVED
2004 NOV 19 PM 1:54
KING COUNTY COUNCIL
CLERK

Attachments

A. Proposed RID for NE 52nd Street Map, B. Assessment Roll - King County Road Improvement District 133 - Northeast 52nd Street (Ames Lake Carnation Road to 298th Avenue Northeast) dated 11/8/04

ATTACHMENT A

15058

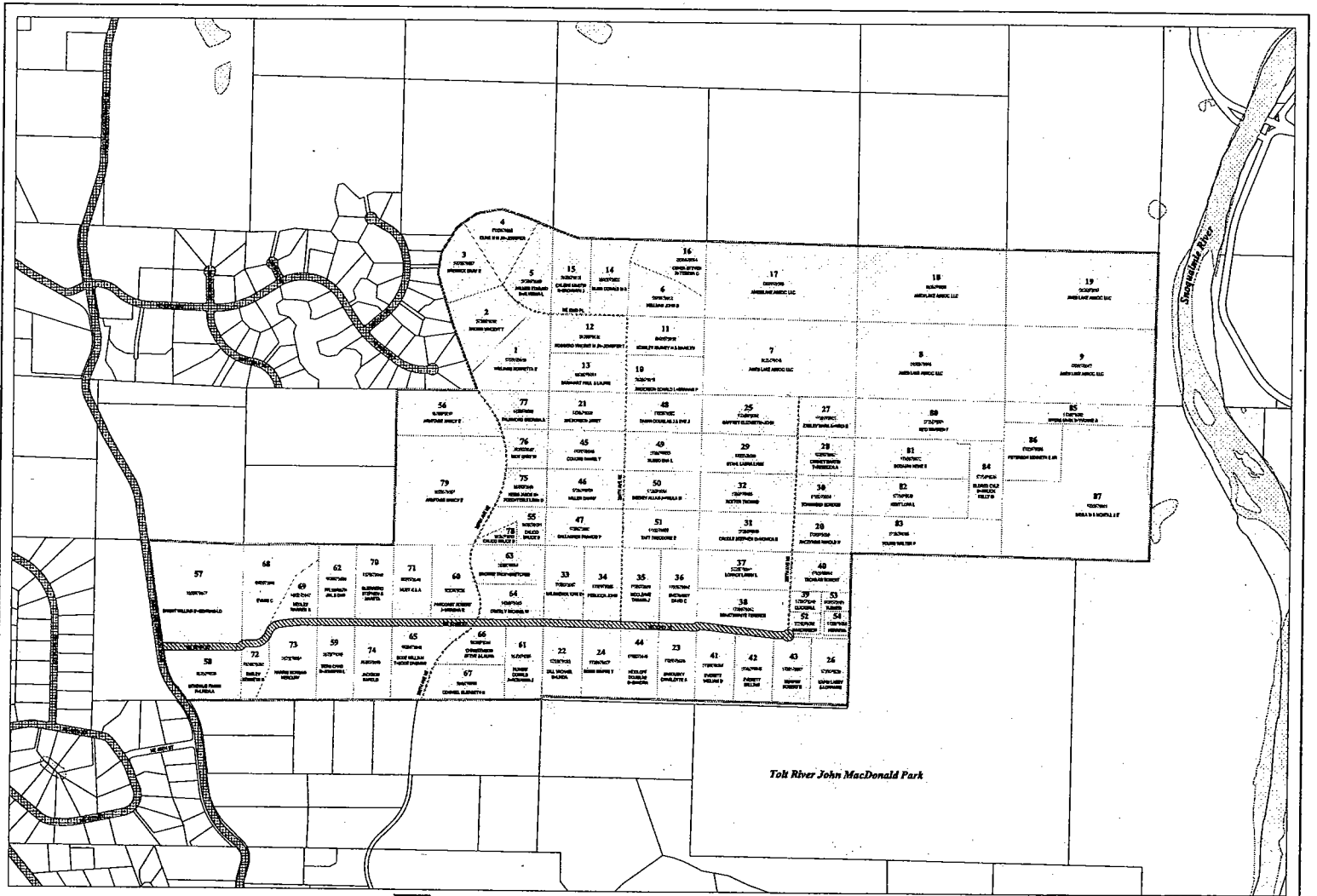

Proposed RID

For NE 52nd Street

- RID Assessment Area
- Improvement Area
- Existing Maintained Roads
- Parcels proposed to be assessed \$ 5,299.62 each
- Private Road Easements
- Water Area
- Parks
- Incorporated Area



King County

The information included on this map has been provided by King County and is not a warranty, endorsement, or recommendation of any product, service, or organization. King County does not assume any liability for any errors or omissions. The information is provided for informational purposes only and is not intended to be used as a basis for any legal action. The information is provided as is and without warranty of any kind. King County is not responsible for any damages, including consequential damages, arising from the use of this information. The information is provided for informational purposes only and is not intended to be used as a basis for any legal action. The information is provided as is and without warranty of any kind. King County is not responsible for any damages, including consequential damages, arising from the use of this information.

King County Overview



ATTACHMENT "B"
ASSESSMENT ROLL - KING COUNTY ROAD IMPROVEMENT DISTRICT 133
 Northeast 52nd Street (Ames Lake Carnation Road to 298th Avenue Northeast) 11/8/04

Parcel No.	Name of Owner	Legal Description	Assessment
1	0725079016-00 Noretta Williams 10201 NE 23 St Bellevue, WA 98004	LOT C-1 OF KC SHORT PLAT NO 977007 REC NO 7712270467 SD PLAT DAF - POR OF NE 1/4 OF SE 1/4 SEC 07 TWP 25 RNG 7 LY S & E OF C/L OF ABANDONED RR GRADE AS WAS ON 6/26/44 TGW POR OF SE 1/4 OF SE 1/4 LY ELY OF SD RR GRADE C/L	\$5,361.24
2	0725079039-03 Vincent Brown 29127 NE 62 Pl Carnation, WA 98014	LOT D-1 KC SHORT PLAT #178050 REC AF #7909280988 SD SHORT PLAT DAF THAT POR OF THE SE 1/4 SEC 7 TWP 25 RNG 7 KNOWN AS LOT C-2 OF SHORT PLAT #977007 AS FILED UNDER RECORDING NUMBER 7712270467 SUBJ TO RESERVATIONS & ESMTS OF RECORD	\$5,361.24
3	0725079057-00 Gary Breiwick 29105 NE 62 Pl Carnation, WA 98014	LOT D-2 KC SHORT PLAT # 178050 REC AF #7909280988 SD SHORT PLAT DAF THAT POR OF THE SE 1/4 SEC 7 TWP 25 RNG 7 KNOWN AS LOT C-2 OF SHORT PLAT #977007 AS FILED UNDER RECORDING NUMBER 7712270467 SUBJ TO RESERVATIONS & ESMTS OF RECORD	\$5,361.24
4	0725079058-09 M. Jr & Jennifer Cline 29104 NE 62 Pl Carnation, WA 98014	LOT D-3 KC SHORT PLAT #178050 REC AF #7909280988 SD SHORT PLAT DAF THAT POR OF THE SE 1/4 SEC 7 TWP 25 RNG 7 KNOWN AS LOT C-2 OF SHORT PLAT #977007 AS FILED UNDER RECORDING NUMBER 7712270467 SUBJ TO RESERVATIONS & ESMTS OF RECORD	\$5,361.24
5	0725079059-08 Edmund & Alverna Palmer 29138 NE 62 Pl Carnation, WA 98014	LOT D-4 KC SHORT PLAT #178050 REC AF #7909280988 SD SHORT LAT DAF THAT POR OF THE SE 1/4 SEC 7 TWP 25 RNG 7 KNOWN AS LOT C-2 OF SHORT PLAT #977007 AS FILED UNDER RECORDING NUMBER 7712270467 SUBJ TO RESERVATIONS & ESMTS OF RECORD	\$5,361.24
6	0825079012-03 John Hellman 6200 - 294 Ave NE Carnation, WA 98014	LOT B-1 KC SHORT PLAT #677042 REC UNDER AF #7904060819 SD SHORT PLAT DAF THE N 1/2 OF SW 1/4 OF SW 1/4 SEC 8 TWP 25 RNG 7 TGW THAT POR OF NW 1/4 OF SW 1/4 SEC 8 TWP 25 RNG 7 BEG AT SW COR SD SUBD TH NLY ALG W LN SD SUBD 81.78 FT TH SELY 229.55 FT M/L TAP WCH IS ON S LN OF SD SUBD & 214.55 FT E OF SW COR THOF TH WLY ALG SD S LN 214.55 FT TO POB SUBJ TO RESERVATION OF C/M RGTS & ESMTS OF RECORD	\$5,361.24
7	0825079013-02 Ames Lake Associates, LLC 18306 Driftwood Drive E. Sumner, WA 98390	S 1/2 OF SE 1/4 OF SW 1/4 SEC 08 TWP 25 RNG 7 THIS PARCEL DESIGNATED FOREST LAND PURSUANT TO SUBSECTION (3) OF RCW 84.33.120 OF 84.33.130	\$5,361.24

Parcel No.	Name of Owner	Legal Description	Assessment
8	0825079016-09 Ames Lake Associates, LLC 18306 Driftwood Drive E. Sumner, WA 98390	S 1/2 OF SW 1/4 OF SE 1/4 SEC 08 TWP 25 RNG 7 THIS PARCEL DESIGNATED FOREST LAND PURSUANT TO SUBSECTION (3) OF RCW 84.33.120 OR 84.33.130	\$5,361.24
9	0825079017-08 Ames Lake Associates, LLC 18306 Driftwood Drive E. Sumner, WA 98390	S 1/2 OF SE 1/4 OF SE 1/4 SEC 08 TWP 25 RNG 7 THIS PARCEL DESIGNATED FOREST LAND PURSUANT TO SUBSECTION (3) OF RCW 84.33.120 OR 84.33.130	\$5,361.24
10	0825079018-07 Donald & Graham Anderson 6016 - 294 Ave NE Carnation, WA 98014	LOT A-1 KC SP 677041 REC AF # 7809130795 SD SP DAF S 1/2 OF SW 1/4 OF SW 1/4 SEC 08 TWP 25 RNG 7	\$5,361.24
11	0825079019-06 Harvey & Marilyn Stanley 6120 - 294 Ave NE Carnation, WA 98014	LOT A-2 KC SP 677041 REC AF # 7809130795 SD SP DAF S 1/2 OF SW 1/4 OF SW 1/4 SEC 08 TWP 25 RNG 7	\$5,361.24
12	0825079020-03 Vincent & Jennifer Roggero 29325 NE 62 Pl Carnation, WA 98014	LOT A-3 KC SP 677041 REC AF # 7809130795 SD SP DAF S 1/2 OF SW 1/4 OF SW 1/4 SEC 08 TWP 25 RNG 7	\$5,361.24
13	0825079021-02 Paul & Laurie Barnhart 6017 - 294 Ave NE Carnation, WA 98014	LOT A-4 KC SP 677041 REC AF # 7809130795 SD SP DAF S 1/2 OF SW 1/4 OF SW 1/4 SEC 08 TWP 25 RNG 7	\$5,361.24
14	0825079022-01 Don Blair & Kathleen Bemis 29320 NE 62 Pl Carnation, WA 98014	LOT B-2 KC SHORT PLAT #677042 REC UNDER AF #7904060819 SD SHORT PLAT DAF THE N 1/2 OF SW 1/4 OF SW 1/4 SEC 8 TWP 25 RNG 7 TGW THAT POR OF NW 1/4 OF SW 1/4 SEC 8 TWP 25 RNG 7 BEG AT SW COR SD SUBD TH NLY ALG W LN SD SUBD 81.78 FT TH SELY 229.55 FT M/L TAP WCH IS ON S LN OF SD SUBD & 214.55 FT E OF SW COR THOF TH WLY ALG SD S LN 214.55 FT TPOB SUBJ TO RESERVATION OF C/M RGTS & ESMTS OF RECORD	\$5,361.24
15	0825079023-00 Martin & Bronwyn Calsyn 29210 NE 62 St Carnation, WA 98014	LOT B-3 KC SHORT PLAT #677042 REC UNDER AF #7904060819 SD SHORT PLAT DAF THE N 1/2 OF SW 1/4 OF SW 1/4 SEC 8 TWP 25 RNG 7 TGW THAT POR OF NW 1/4 OF SW 1/4 SEC 8 TWP 25 RNG 5 BEG AT SW COR SD SUBD TH NLY ALG W LN SD SUBD 81.78 FT TH SELY 229.55 FT M/L TAP WCH IS ON S LN OF SD SUBD & 214.55 FT E OF SW COR THOF TH WLY ALG SD S LN 214.55 FT TPOB SUBJ TO RESERVATION OF C/M RGTS & ESMTS OF RECORD	\$5,361.24

ATTACHMENT "B"

ASSESSMENT ROLL - KING COUNTY ROAD IMPROVEMENT DISTRICT 133
Northeast 52nd Street (Ames Lake Carnation Road to 298th Avenue Northeast) 11/8/04

Parcel No.	Name of Owner	Legal Description	Assessment
16	0825079024-09 Steven & Teresa Oshea 29414 NE 64 th Way Carnation, WA 98014	LOT B-4 KC SHORT PLAT #677042 REC UNDER AF #7904060819 SD SHORT PLAT DAF THE N 1/2 OF SW 1/4 OF SW 1/4 SEC 8 TWP 25 RNG 7 TGW THAT POR OF NW 1/4 OF SW 1/4 SEC 8 TWP 25 RNG 7 BEG AT SW COR SD SUBD TH NLY ALG W LN SD SUBD 81.78 FT TH SELY 229.55 FT M/L TAP WCH IS ON S LN SD SUBD & 214.55 FT E OF SW COR THOF TH WLY ALG SD S LN 214.55 FT TPOB SUBJ TO RESERVATION OF C/M RGTS & ESMTS OF RECORD	\$5,361.24
17	0825079025-08 Ames Lake Associates, LLC 18306 Driftwood Drive E. Sumner, WA 98390	N 1/2 OF SE 1/4 OF SW 1/4 SEC 08 TWP 25 RNG 7 THIS PARCEL DESIGNATED FOREST LAND PURSUANT TO SUBSECTION (3) OF RCW 84.33.120 OF 84.33.130	\$5,361.24
18	0825079026-07 Ames Lake Associates, LLC 18306 Driftwood Drive E. Sumner, WA 98390	N 1/2 OF SW 1/4 OF SE 1/4 SEC 08 TWP 25 RNG 7 THIS PARCEL DESIGNATED FOREST LAND PURSUANT TO SUBSECTION (3) OF RCW 84.33.120 OR 84.33.130	\$5,361.24
19	0825079027-06 Ames Lake Associates, LLC 18306 Driftwood Drive E. Sumner, WA 98390	N 1/2 OF SE 1/4 OF SE 1/4 SEC 08 TWP 25 RNG 7 THIS PARCEL DESIGNATED FOREST LAND PURSUANT TO SUBSECTION (3) OF RCW 84.33.120 OR 84.33.130	\$5,361.24
20	1725079005-01 Harold Raczynski 5522 - 298 Ave NE Carnation, WA 98014	LOT 3 KC SHORT PLAT NO 476100 REC NO 7703010796 SD PLAT DAF S 1/2 OF NE 1/4 OF NW 1/4 SEC 17 TWP 25 RNG 7	\$5,361.24
21	1725079006-00 Janet Halvorson P.O. Box 561 Carnation, WA 98014	LOT 1 KC SHORT PLAT #876045 AF #7806130635 SD SHORT PLAT DAF W 1/2 OF NW 1/4 OF NW 1/4 SEC 17 TWP 25 RNG 7	\$5,361.24
22	1725079025-07 Michael & Linda Dill 29207 NE 52 St Carnation, WA 98014	PARCEL 1 KC SHORT PLAT NO 176020 REC NO 7704150929 SD PLAT DAF - S 1/2 OF SW 1/4 OF NW 1/4 SEC 17 TWP 25 RNG 7 LESS S 30 FT THOF	\$5,361.24
23	1725079026-06 Charlotte Sandusky 4415 NE 60 St Seattle, WA 98115	PARCEL 4 KC SHORT PLAT NO 176020 REC NO 7704150929 SD PLAT DAF - S 1/2 OF SW 1/4 OF NW 1/4 SEC 17 TWP 25 RNG 7 LESS S 30 FT THOF	\$5,361.24
24	1725079027-05 Wayne Rubin 29335 NE 52nd Street Carnation, WA 98014	PARCEL 2 KC SHORT PLAT NO 176020 REC NO 7704150929 SD PLAT DAF - S 1/2 OF SW 1/4 OF NW 1/4 SEC 17 TWP 25 RNG 7 LESS S 30 FT THOF	\$5,361.24
25	1725079028-04 John & Elizabeth Gaffney 5909 - 298 Ave NE Carnation, WA 98014	PP ACT 39905633 MOBILE HOME LOT 1 KC SHORT PLAT NO 476101 REC NO 7703010797 SD PLAT DAF N 1/2 OF NE 1/4 OF NW 1/4 SEC 17 TWP 25 RNG 7	\$5,361.24

Parcel No.	Name of Owner	Legal Description	Assessment
26	1725079029-03 Larry & Lorraine Kapin 29901 NE 52 St Carnation, WA 98014	PARCEL 4 KC SHORT PLAT NO 576046 REC #7704281053 SD SP DAF POR OF SE 1/4 OF NW 1/4 SEC 17 TWP 25 RNG 7 LY SLY OF NLY LN 60 FT RD ESMT REC NO 7603120429 LESS S 30 FT THOF	\$5,361.24
27	1725079031-09 Mark & Heidi Ensley 5902 - 298 Ave NE Carnation, WA 98014	PP ACT 39926175 MOBILE HOME LOT 2 KC SHORT PLAT NO 476101 REC NO 7703010797 SD PLAT DAF N 1/2 OF NE 1/4 OF NW 1/4 SEC 17 TWP 25 RNG 7	\$5,361.24
28	1725079032-08 Martin & Rebecca Chaney 5802 - 298 Ave NE Carnation, WA 98014	LOT 3 KC SHORT PLAT NO 476101 REC NO 7703010797 SD PLAT DAF N 1/2 OF NE 1/4 OF NW 1/4 SEC 17 TWP 25 RNG 7	\$5,361.24
29	1725079033-07 Laura Stahl 5801 - 298 Ave NE Carnation, WA 98014	LOT 4 KC SHORT PLAT NO 476101 REC NO 7703010797 SD PLAT DAF N 1/2 OF NE 1/4 OF NW 1/4 SEC 17 TWP 25 RNG 7	\$5,361.24
30	1725079034-06 Gordon Townsend 5616 - 298 Ave NE Carnation, WA 98014	LOT 2 KC SHORT PLAT NO 476100 REC NO 7703010796 SD PLAT DAF S 1/2 OF NE 1/4 OF NW 1/4 SEC 17 TWP 25 RNG 7	\$5,361.24
31	1725079035-05 Stephen & Monica Crodle 5511 - 298 Ave NE Carnation, WA 98014	PP ACT 38346193 MOBILE HOME LOT 4 KC SHORT PLAT NO 476100 REC NO 7703010796 SD PLAT DAF S 1/2 OF NE 1/4 OF NW 1/4 SEC 17 TWP 25 RNG 7	\$5,361.24
32	1725079036-04 Thomas Rotter 5615 - 298 Ave NE Carnation, WA 98014	PP ACT 39926183 MOBILE HOME LOT 1 KC SHORT PLAT NO 476100 REC NO 7703010796 SD PLAT DAF S 1/2 OF NE 1/4 OF NW 1/4 SEC 17 TWP 25 RNG 7	\$5,361.24
33	1725079037-03 Kirk & Nancy Kalbrener 29216 NE 52 St Carnation, WA 98014	LOT 1 KC SHORT PLAT NO 576009 REC NO 7704150928 SD PLAT DAF - N 1/2 OF SW 1/4 OF NW 1/4 SEC 17 TWP 25 RNG 7	\$5,361.24
34	1725079038-02 John Perucca 13408 Graywolf Pl NE Poulsbo, WA 98370	LOT 2 KC SHORT PLAT NO 576009 REC NO 7704150928 SD PLAT DAF - N 1/2 OF SW 1/4 OF NW 1/4 SEC 17 TWP 25 RNG 7	\$5,361.24
35	1725079039-01 Tamara McCleave 5218 - 294 Ave NE Carnation, WA 98014	LOT 3 KC SHORT PLAT NO 576009 REC NO 7704150928 SD PLAT DAF - N 1/2 OF SW 1/4 OF NW 1/4 SEC 17 TWP 25 RNG 7	\$5,361.24
36	1725079040-08 David Svitavsky 29504 NE 52 St Carnation, WA 98014	LOT 4 KC SHORT PLAT NO 576009 REC NO 7704150928 SD PLAT DAF - N 1/2 OF SW 1/4 OF NW 1/4 SEC 17 TWP 25 RNG 7	\$5,361.24
37	1725079041-07 Larry Lorack 5409 - 298 Ave NE Carnation, WA 98014	PARCEL 1 KC SHORT PLAT NO 576045 REC NO 7704150927 SD PLAT DAF- POR OF SE 1/4 OF NW 1/4 SEC 17 TWP 25 RNG 7 LY NLY OF 60 FT RD ESMT REC NO 7603120429	\$5,361.24

ATTACHMENT "B"

ASSESSMENT ROLL - KING COUNTY ROAD IMPROVEMENT DISTRICT 133

Northeast 52nd Street (Ames Lake Carnation Road to 298th Avenue Northeast) 11/8/04

Parcel No.	Name of Owner	Legal Description	Assessment
38	1725079042-06 Terence Branthwaite 5225 - 298 Ave NE Carnation, WA 98014	PARCEL 2 KC SHORT PLAT NO 576045 REC NO 7704150927 SD PLAT DAF-POR OF SE 1/4 OF NW 1/4 SEC 17 TWP 25 RNG 7 LY NLY OF L0 FT RD ESMT REC NO 7603120429	\$5,361.24
39	1725079043-05 John & Colleen Quicksall 5230 - 298 Ave NE Carnation, WA 98014	LOT 1 KCSP #185001 REC #8903299001 SD SP DAF LOT 3 KCSP #576045 REC #7704150927 BEING A POR OF SE 1/4 OF NW 1/4 SEC 17 TWP 25 RNG 7 LY N OF EXISTING RD ESMT	\$5,361.24
40	1725079044-04 Robert Tschilar 5400 - 298 Ave NE Carnation, WA 98014	PP ACT 39926191 MOBILE HOME PARCEL 4 KC SHORT PLAT NO 576045 REC NO 7704150927 SD PLAT DAF-POR OF SE 1/4 OF NW 1/4 SEC 17 TWP 25 RNG 7 LY NLY OF 60 FT RD ESMT REC NO 7603120429	\$5,361.24
41	1725079045-03 William Everett P.O. Box 3487 Redmond, WA 98073	PARCEL 1 KC SHORT PLAT NO 576046 REC NO 7704281053 SD PLAT DAF-POR OF SE 1/4 OF NW 1/4 SEC 17 TWP 25 RNG 7 LY SLY OF NLY LN 60 FT RD ESMT REC NO 7603120429 LESS S 30 FT THOF	\$5,361.24
42	1725079046-02 William Everett P.O. Box 3487 Redmond, WA 98073	PARCEL 2 KC SHORT PLAT NO 576046 REC NO 7704281053 SD PLAT DAF POR OF SE 1/4 OF NW 1/4 SEC 17 TWP 25 RNG 7 LY SLY OF NLY LN 60 FT RD ESMT REC NO 7603120429 LESS S 30 FT THOF	\$5,361.24
43	1725079047-01 Robert Murphy 29803 NE 52 St Carnation, WA 98014	PARCEL 3 KC SHORT PLAT NO 576046 REC NO 7704281053 SD PLAT DAF POR OF SE 1/4 OF NW 1/4 SEC 17 TWP 25 RNG 7 LY SLY OF NLY LN 60 FT RD ESMT REC NO 7603120429 LESS S 30 FT THOF	\$5,361.24
44	1725079048-00 Douglas & Sandra Heidloff 980 SW 167 Pl Beaverton, OR 97006	PARCEL 3 KC SHORT PLAT NO 176020 REC NO 7704150929 SD PLAT DAF - S 1/2 OF SW 1/4 OF NW 1/4 SEC 17 TWP 25 RNG 7 LESS S 30 FT THOF	\$5,361.24
45	1725079049-09 Daniel Collins 5815 - 294 Ave NE Carnation, WA 98014	PP ACT 39926217 MOBILE HOME LOT 2 KC SHORT PLAT #876045 AF #7806130635 SD SHORT PLAT DAF W 1/2 OF NW 1/4 OF NW 1/4 SEC 17 TWP 25 RNG 7	\$5,361.24
46	1725079050-05 Danny Miller 5623 - 294 Ave NE Carnation, WA 98014	LOT 3 KC SHORT PLAT #876045 AF #7806130635 SD SHORT PLAT DAF W 1/2 OF NW 1/4 OF NW 1/4 SEC 17 TWP 25 RNG 7	\$5,361.24
47	1725079051-04 Francis Gallagher 5603 - 294 Ave NE Carnation, WA 98014	LOT 4 KING CO SHORT PLAT NO 876045 RECORDING NO 7806130635 BEING A PORTION OF NW 1/4 NW 1/4 STR SEC 17 TWP 25 RNG 7	\$5,361.24
48	1725079052-03 Douglas & Eve Dakan 5918 - 294 Ave NE Carnation, WA 98014	LOT 1 KC SHORT PLAT #876046 AF #7806130636 SD SHORT PLAT DAFE 1/2 OF NW 1/4 OF NW 1/4 OF SEC 17 TWP 25 RNG 7	\$5,361.24
49	1725079053-02 Ena Russo 6034 - 142 Ct NE Redmond, WA 98052	LOT 2 KC SHORT PLAT #876046 AF #7806130636 SD SHORT PLAT DAFE 1/2 OF NW 1/4 OF NW 1/4 OF SEC 17 TWP 25 RNG 7	\$5,361.24

Parcel No.	Name of Owner	Legal Description	Assessment
50	1725079054-01 Allan & Paula Beene 5612-294 Ave NE Carnation, WA 98014	LOT 3 KC SHORT PLAT #876046 AF #7806130636 SD SHORT PLAT DAFE 1/2 OF NW 1/4 OF NW 1/4 OF SEC 17 TWP 25 RNG 7	\$5,361.24
51	1725079055-00 Theodore Taft 11135 - 157 Ave NE Redmond, WA 98052	LOT 4 KC SHORT PLAT #876046 AF #7806130636 SD SHORT PLAT DAFE 1/2 OF NW 1/4 OF NW 1/4 OF SEC 17 TWP 25 RNG 7	\$5,361.24
52	1725079060-03 Peter Emhoff & Edit Marcinkech 5214-298 Ave NE Carnation, WA 98014	LOT 2 KCSP #185001 REC #8903299001 SD SP DAF LOT 3 KCSP #576045 REC #7704150927 BEING A POR OF SE 1/4 OF NW 1/4 SEC 17 TWP 25 RNG 7 LY N OF EXISTING RD ESMT	\$5,361.24
53	1725079061-02 Michael & Sheila Turner 29904 NE 52 St Carnation, WA 98014	LOT 3 KCSP #185001 REC #8903299001 SD SP DAF LOT 3 KCSP #576045 REC #7704150927 BEING A POR OF SE 1/4 OF NW 1/4 SEC 17 TWP 25 RNG 7 LY N OF EXISTING RD ESMT	\$5,361.24
54	1725079062-01 Jesse & Frances Herrera 29908 NE 52 St Carnation, WA 98014	LOT 4 KCSP #185001 REC #8903299001 SD SP DAF LOT 3 KCSP #576045 REC #7704150927 BEING A POR OF SE 1/4 OF NW 1/4 SEC 17 TWP 25 RNG 7 LY N OF EXISTING RD ESMT	\$5,361.24
55	1825079001-04 Bruce Calico 5516 - 290 Ave NE Carnation, WA 98014	PARCEL 1 KC SHORT PLAT NO 1275044 REC NO 7604020599 SD PLAT DAF POR OF NE 1/4 OF NE 1/4 SEC 18 TWP 25 RNG 7 LY ELY OF ABANDONED LOGGING GRADE IN SD NE 1/4 OF NE 1/4 AKA PRESENT EXISTING 60 FT ESMT RD LESS POR SD PARCEL 1 DAF BEG SE COR OF NE 1/4 OF NE 1/4 TH S 87-58-26 W ALG S LN THOF 252.95 FT TO TPOB TH CONT S 87-58-26 W 375.50 FT TO C/L ABANDONED LOGGING GRADE TH NLY ALG SD C/L 50 FT TH NELY TAP WCH BEARS N 0-59-36 W 200 FT FR TPOB TH S 0-59-36 E 200 FT TO TPOB	\$5,361.24
56	1825079017-06 Nancy Armitage 5821 - 290 Ave NE Carnation, WA 98014	THAT POR OF NE 1/4 OF NE 1/4 SEC 18-25-7-BEG NW COR SD SUBD TH SLY ALG W LN THOF DIST 400 FT TH ELY TO C/L ABANDONED RR GRADE TH NWLY ALG SD RR R/W TO N LN SD SUBD TH WLY ALG SD N LN DIST 680.38 FT TO POB -TAXABLE PORTION PARTIALLY EXEMPT UNDER RCW 84.36.381 THRU .389	\$5,361.24
57	1825079027-04 William Bright & Lo Gehring 5701 Seaview NW Seattle, WA 98107	POR OF SE 1/4 OF NW 1/4 SEC 18 TWP 25 RNG 7 LY ELY OF CO RD LESS S 450 FT	\$5,361.24
58	1825079028-03 Frank & Linda Sebenius 5030 Ames Lake Rd Carnation, WA 98014	S 450 FT OF POR OF SE 1/4 OF NW 1/4 SEC 18 TWP 25 RNG 7 LY ELY OF AMES LAKE RD	\$5,361.24
59	1825079035-04 Chad & Jennifer Berg 28627 NE 52 St Carnation, WA 98014	PARCEL C KING CO SHORT PLAT NO 573056 REC NO 7603080520 BEING A REVISION OF REC NO 7512180489 SD SP DAF: POR OF SW QTR OF NE QTR SEC 18 TWP 25 RNG 7 LY SLY OF C/L OF RD ESMT AS DESCRIBED IN AF #7210260546	\$5,361.24

ATTACHMENT "B"
 ASSESSMENT ROLL - KING COUNTY ROAD IMPROVEMENT DISTRICT 133
 Northeast 52nd Street (Ames Lake Carnation Road to 298th Avenue Northeast) 11/8/04

Parcel No.	Name of Owner	Legal Description	Assessment
60	1825079036-03 Robert & Marsha Pancoast P.O. Box 568 Carnation, WA 98014	PARCEL B KC SHORT PLAT NO 174019 REC NO 7504160610 SD PLAT DAF N 1/2 OF SE 1/4 OF NE 1/4 SEC 18 TWP 25 RNG 7	\$5,361.24
61	1825079037-02 Donald & Roxanna Hubert 29103 NE 52 St Carnation, WA 98014	TR C KC SHORT PLAT NO 374004 REC NO 7504220563 DAF S 1/2 OF SE 1/4 OF NE 1/4 SEC 18 TWP 25 RNG 7	\$5,361.24
62	1825079038-01 Dan & Jill Pflugrath 28614 NE 52 St Carnation, WA 98014	PARCEL C KC SHORT PLAT NO 1173004 REC NO 7512180488 DAF POR OF SW 1/4 OF NE 1/4 SEC 18 TWP 25 RNG 7 LY NLY OF C/L OF RD ESMT AF 7210260546	\$5,361.24
63	1825079041-06 Troy & Gretchen Browne 5402 - 290 Ave NE Carnation, WA 98014	PARCEL C OF KC SHORT PLAT NO 174019 REC NO 7504160610 SD PLAT DAF N 1/2 OF SE 1/4 OF NE 1/4 SEC 18 TWP 25 RNG 7	\$5,361.24
64	1825079042-05 Michael O'Reilly 3052 231 st Ln SE. Apt C202 Sammamish, WA 98075	PARCEL D OF KC SHORT PLAT NO 174019 REC NO 7504160610 SD PLAT DAF N 1/2 OF SE 1/4 OF NE 1/4 SEC 18 TWP 25 RNG 7	\$5,361.24
65	1825079043-04 William & Dagmar Sode 1805 - 134 Ave SE, #10 Bellevue, WA 98005	TR A KC SHORT PLAT NO 374004 REC NO 7504220563 DAF S 1/2 OF SE 1/4 OF NE 1/4 SEC 18 TWP 25 RNG 7	\$5,361.24
66	1825079044-03 Steve & Laura Christenson 29021 NE 52 St Carnation, WA 98014	PP ACT 39926894 MOBILE HOME TR B KC SHORT PLAT NO 374004 REC NO 7504220563 DAF S 1/2 OF SE 1/4 OF NE 1/4 SEC 18 TWP 25 RNG 7	\$5,361.24
67	1825079045-02 Elizabeth Connell 5020 - 290 Ave NE Carnation, WA 98014	TR D KC SP #374004 REC #7504220563 SD SP DAF S 1/2 OF SE 1/4 OF NE 1/4 SEC 18-25-7	\$5,361.24
68	1825079046-01 C Evans 1354 P.O. Box 257 Olympia, WA 98507	PARCEL A KC SHORT PLAT NO 1173004 REC NO 7512180488 DAF POR OF SW 1/4 OF NE 1/4 SEC 18 TWP 25 RNG 7 LY NLY OF C/L OF RD ESMT AF 7210260546	\$5,361.24
69	1825079047-00 Warren Medley 28520 NE 52 St Carnation, WA 98014	PARCEL B KC SHORT PLAT NO 1173004 REC NO 7512180488 DAF POR OF SW 1/4 OF NE 1/4 SEC 18 TWP 25 RNG 7 LY NLY OF C/L OF RD ESMT AF 7210260546	\$5,361.24
70	1825079048-09 Stephen & Mareta Guerrero P.O. Box 2114 Redmond, WA 98073	PARCEL D KC SHORT PLAT NO 1173004 REC NO 7512180488 DAF POR OF SW 1/4 OF NE 1/4 SEC 18 TWP 25 RNG 7 LY NLY OF C/L RD ESMT AF 7210260546	\$5,361.24
71	1825079049-08 K & A Huet 28754 NE 52 St Carnation, WA 98014	PP ACT 37304169 MOBILE HOME PARCEL A KC SHORT PLAT NO 174019 REC NO 7504160610 SD PLAT DAF N 1/2 OF SE 1/4 OF NE 1/4 SEC 18 TWP 25 RNG 7	\$5,361.24

Parcel No.	Name of Owner	Legal Description	Assessment
72	1825079050-04 Kenneth Easley 28413 NE 52 St Carnation, WA 98014	PARCEL A KING CO SHORT PLAT NO 573056 REC NO 7603080520 BEING A REVISION OF REC NO 7512180489 SD SP DAF: POR OF SW QTR OF NE QTR SEC 18 TWP 25 RNG 7 LY SLY OF C/L OF RD ESMT AS DESCRIBED IN AF #7210260546	\$5,361.24
73	1825079051-03 Morgan Harris 28415 NE 52 St Carnation, WA 98014	PARCEL B KING CO SHORT PLAT NO 573056 REC NO 7603080520 BEING A REVISION OF REC NO 7512180489 SD SP DAF: POR OF SW QTR OF NE QTR SEC 18 TWP 25 RNG 7 LY SLY OF C/L OF RD ESMT AS DESCRIBED IN AF #7210260546	\$5,361.24
74	1825079052-02 Harold Jackson 28417 NE 52 St Carnation, WA 98014	PARCEL D KING CO SHORT PLAT NO 573056 REC NO 7603080520 BEING A REVISION OF REC NO 7512180489 SD SP DAF: POR OF SW QTR OF NE QTR SEC 18 TWP 25 RNG 7 LY SLY OF C/L OF RD ESMT AS DESCRIBED IN AF #7210260546	\$5,361.24
75	1825079056-08 John & Sandi O'Donnell 5702 - 290 Ave NE Carnation, WA 98014	PARCEL 2 KC SHORT PLAT NO 1275044 REC NO 7604020599 SD PLAT DAF POR OF NE 1/4 OF NE 1/4 SEC 18 TWP 25 RNG 7 LY ELY OF ABANDONED LOGGING GRADE IN SD NE 1/4 OF NE 1/4 AKA PRESENT EXISTING 60 FT ESMT RD	\$5,361.24
76	1825079057-07 Gary Woy P.O. Box 739 Issaquah, WA 98027	PARCEL 3 KC SHORT PLAT NO 1275044 REC NO 7604020599 SD PLAT DAF POR OF NE 1/4 OF NE 1/4 SEC 18 TWP 25 RNG 7 LY ELY OF ABANDONED LOGGING GRADE IN SD NE 1/4 OF NE 1/4 AKA PRESENT EXISTING 60 FT ESMT RD	\$5,361.24
77	1825079058-06 Georgia Thurmond 5916 - 290 Ave NE Carnation, WA 98014	PARCEL 4 KC SHORT PLAT NO 1275044 REC NO 7604020599 SD PLAT DAF POR OF NE 1/4 OF NE 1/4 SEC 18 TWP 25 RNG 7 LY ELY OF ABANDONED LOGGING GRADE IN SD NE 1/4 OF NE 1/4 AKA PRESENT EXISTING 60 FT ESMT RD	\$5,361.24
78	1825079065-07 merged with parcel 55 Bruce Calico 5516 - 290 Ave NE Carnation, WA 98014	POR OF NE 1/4 OF NE 1/4 BEG SE COR SD NE 1/4 OF NE 1/4 SEC 18 TH S 87-58-26 W ALG S LN THOF 252.95 FT TO TPOB TH CONT S 87-58-26 W 375.50 FT TO C/L ABANDONED LOGGING GRADE TH NLY ALG SD C/L 50 FT TH NELY TAP WCH BEARS N 0-59-36 W 200 FT FR TPOB TH S 0-59-36 E 200 FT TO TPOB AKA POR PAR 1 KC SHORT PLAT #1275044 REC #7604020599 SD PLAT DAF POR OF NE 1/4 OF NE 1/4 LY ELY OF ABANDONED LOGGING GRADE IN SD NE 1/4 OF NE 1/4 AKA PRESENT EXISTING 60 FT ESMT RD	0.00
79	1825079067-05 Nancy Armitage 5821 - 290 Ave NE Carnation, WA 98014	POR OF THE NE 1/4 OF NE 1/4 OF SEC 18 TWP 25 RNG 7 DAF LY WLY OF THE ABANDONED RR R/W AND SLY OF A LN DAF BEG AT NW COR OF SD SUBD TH SLY ALG THE W LN THOF A DIST OF 400 FT AND BEG OF SD LN	\$5,361.24
80	1725079021-01 Reid Warren F 2315 248th Ave SE Sammamish WA 98075	N 1/2 OF N 1/2 OF NW 1/4 OF NE 1/4 SEC 17 TWP 25 RNG 7	\$5,361.24

ATTACHMENT "B"

ASSESSMENT ROLL - KING COUNTY ROAD IMPROVEMENT DISTRICT 133

Northeast 52nd Street (Ames Lake Carnation Road to 298th Avenue Northeast) 11/8/04

Parcel No.	Name of Owner	Legal Description	Assessment
81	1725079022-00 Sodamin Heinz K Linda S Zeppa 5817 302ND Ave NE Carnation WA 98014	PARCEL 1 KC SHORT PLAT #776009 AF #7609150565 SD SHORT PLAT DAF S 1/2 OF N 1/2 & N 1/2 OF S 1/2 OF NW 1/4 OF NE 1/4 SEC 17 TWP 25 RNG 7	\$5,361.24
82	1725079020-02 Kent Lora L 5706 302ND Ave NE Carnation WA 98014	PARCEL 2 KC SHORT PLAT #776009 AF #7609150565 SD SHORT PLAT DAF S 1/2 OF N 1/2 & N 1/2 OF S 1/2 OF NW 1/4 OF NE 1/4 SEC 17 TWP 25 RNG 7	\$5,361.24
83	1725079002-04 Young Walter P 5526 302ND Ave NE Carnation WA 98014	S 1/2 OF S 1/2 OF NW 1/4 OF NE 1/4 SEC 17 TWP 25 RNG 7	\$5,361.24
84	1725079024-08 Eldred Cyle B + Mauck Kelly 5601 302ND Ave NE Carnation WA 98014	PARCEL 3 KC SHORT PLAT #776009 AF #7609150565 SD SHORT PLAT DAF S 1/2 OF N 1/2 & N 1/2 OF S 1/2 OF NW 1/4 OF NE 1/4 SEC 17 TWP 25 RNG 7	\$5,361.24
85	1725079023-09 Myers Mark B+Yvonne A 5830 302ND AV NE Carnation WA 98014	N 1/2 OF N 1/2 OF N 1/2 OF GL 1 IN NE 1/4 SEC 17 TWP 25 RNG 7	\$5,361.24
86	1725079056-09 Peterson Kenneth E SR 5820 302ND Ave NE Carnation WA 98014	LOT 2 KC SHORT PLAT #878003 RECORDED AF #7908140949 SD SHORT PLAT DAF GL 1 SEC 17 TWP 25 RNG 7 EXCEPT N 1/2 OF N 1/2 OF N 1/2 OF NE 1/4 OF NE 1/4 SD SUBD TGW ESMTS OF RECORD	\$5,361.24
87	1725079001-05 Ives A M & McNeill J E 5810 302ND Ave NE Carnation WA 98014	LOT 1 KC SHORT PLAT #878003 RECORDED AF # 7908140949 SD SHORT PLAT DAF GL 1 SEC 17 TWP 25 RNG 7 EXCEPT N 1/2 OF N 1/2 OF N 1/2 OF NE 1/4 OF NE 1/4 SD SUBD TGW ESMTS OF RECORD	\$5,361.24
	Sub Total		\$461,066.64
	Balance (King County Participation)		\$461,066.64
	TOTAL		\$922,133.28

Return Address:
Clerk of the Council
Metropolitan King County Council
Mail stop KCC-CC 1039



20041207000263
KING-COUNTY GO ORD 0.00
PAGE001 OF 019
12/07/2004 11:07
KING COUNTY, WA

Please print or type information **WASHINGTON STATE RECORDER'S Cover Sheet** (RCW 65.04)

Document Title(s) (or transactions contained therein): (all areas applicable to your document <u>must</u> be filled in) 1. ORDINANCE 15058 AN ORDINANCE confirming King County Road Improvement District 133 and ordering the improvement of a portion of Northeast 52nd Street from Ames Lake – Carnation Road Northeast to 298th Avenue Northeast, authorizing interim financing, confirming the final assessment roll and levying assessments against the property within the district.	
Reference Number(s) of Documents assigned or released: Additional reference #'s on page _____ of document	
Grantor(s) (Last name, first name, initials) 1. King County, Washington Additional names on page _____ of document.	
Grantee(s) (Last name first, then first name and initials) 1. King County, Washington 2. _____ Additional names on page _____ of document.	
Legal description (abbreviated: i.e. lot, block, plat or section, township, range) Northeast 52nd Street from Ames Lake – Carnation Road Northeast to 298th Avenue Northeast; ... Additional legal is on page _____ of document.	
Assessor's Property Tax Parcel/Account Number	<input type="checkbox"/> Assessor Tax # not yet assigned
The Auditor/Recorder will rely on the information provided on the form. The staff will not read the document to verify the accuracy or completeness of the indexing information provided herein.	

RECEIVED
2004 DEC -9 AM 10:04
CLERK
KING COUNTY COUNCIL

I am requesting an emergency nonstandard recording for an additional fee as provided in RCW 36.18.010. I understand that the recording processing requirements may cover up or otherwise obscure some part of the text of the original document.

Janet Masno Signature of Requesting Party



KING COUNTY

1200 King County Courthouse
516 Third Avenue
Seattle, WA 98104

Signature Report

November 9, 2004

Ordinance 15058

Proposed No. 2004-0397.2

Sponsors Lambert

1 AN ORDINANCE creating King County Road
2 Improvement District No. 133 and ordering the
3 improvement of a portion of Northeast 52nd Street from
4 Ames Lake – Carnation Road Northeast to 298th Avenue
5 Northeast, authorizing interim financing, confirming the
6 final assessment roll and levying assessments against the
7 property within the district.

8
9
10 **STATEMENT OF FACTS:**

11 1. Pursuant to King County Motion 12016, a public hearing was held on
12 November 8, 2004, on the petitions of property owners within the
13 proposed district for the formation of a road improvement district to
14 improve certain streets, and pursuant to RCW 36.88.060 and 36.88.090,
15 for the purpose of considering the formation and the assessment roll for
16 King County Road Improvement District No. 133.

17 2. Notice of the hearing was duly published and was duly mailed to each
18 property owner pursuant to RCW 36.88.050 and 36.88.090.

19 3. A diagram showing the properties specially benefited by the project
20 and the cost and expense to be borne by each lot or building site was
21 considered by the council.

22 4. All written and verbal protests were considered.

23 5. It is hereby found those petitions, including all additions thereto and
24 withdrawals therefrom made prior to 5:00 p.m. of the business day before
25 the hearing, are sufficient.

26 6. The King County council, sitting as a board of equalization for such
27 purpose, considered the assessment roll and all timely filled written
28 objections made to the confirmation thereof.

29 7. It is further found that all requirements of RCW 36.88.020, 36.88.060 and
30 36.88.090 and King County Motion 12016 have been satisfied.

31 BE IT ORDAINED BY THE COUNCIL OF KING COUNTY:

32 SECTION 1. There is hereby established, pursuant to chapter 36.88 RCW, a road
33 improvement district in King County to be known and designated as "King County Road
34 Improvement District No. 133" ("RID 133"). The district shall include all the territory
35 within the boundaries shown on Attachment A to this ordinance.

36 SECTION 2. The following described streets, which are wholly within RID 133,
37 shall be improved by clearing, grubbing, grading, drainage, surfacing with asphalt
38 concrete and any such other work as may be incidental thereto, in accordance with the

39 request on the petition, which improvements are referred to in this motion as the
40 "project":

41 Northeast 52nd Street from Ames Lake – Carnation Road Northeast to 298th
42 Avenue Northeast; approximately 5,525 feet in total length.

43 SECTION 3. It is hereby found that the plan for improvement or construction in
44 RID 133 is feasible and that the benefits to be derived therefrom by the property within
45 said district exceed the cost and expense of the formation of the district and the
46 contemplated construction or improvement therein.

47 SECTION 4. Total costs and expenses of accomplishing the project are estimated
48 to be \$922,133.00. Approximately fifty percent of the estimated cost for the
49 improvement will be borne by and assessed against property within the boundary of RID
50 133. The portion of the total costs and expenses to be assessed the properties within RID
51 133 shall not exceed \$461,066.94. King County shall contribute the remaining balance of
52 the costs to construct Northeast 52nd Street. The property owner's share of the costs and
53 expenses shall be assessed \$5,361.24 per parcel, all located within the boundary of RID
54 133.

55 The actual amount of the final assessment against each parcel of property within
56 RID 133 shall include a portion of the actual total of such costs and expenses incurred in
57 completing the project and shall become a lien against each such parcel of land within
58 RID 133, upon confirmation of the assessment roll by the council. The assessments may
59 be paid in full within thirty days following confirmation of the final assessment roll and
60 notification by the finance and business operations, treasury operations. The amount of
61 any assessment or any portion thereof against property in RID 133 not paid within the

62 thirty-day period after notification shall be paid in five annual and consecutive
63 installments, together with interest on the diminishing principal balance of such
64 assessment which will be set at one-half of one percent higher than the net effective
65 interest rate on the loan obtained to pay the costs of the improvements on RID 133.

66 Interest shall commence on the thirtieth day following first publication of the
67 finance and business operations notice described in section 8 of this ordinance and the
68 first installment shall be due one year from the date.

69 Interest on the assessment amount due shall be based on the interest bearing
70 warrant rate established by the county's service bank, currently eighty percent of the
71 bank's prime borrowing rate, at the time of confirmation of the final assessment roll.
72 Interest will be added annually to the assessed amount due, beginning from the end of the
73 thirty-day prepay period. The estimated net effective interest rate plus one-half of one
74 percent is estimated at seven percent.

75 Following expiration of thirty days after the first publication, the principal balance
76 of the assessment, together with accrued interest and penalty, if any, may be prepaid only
77 at the times and in the manner determined by the King County finance and business
78 operations, treasury operations. Any prepayment made on any date other than an
79 installment due date shall be accompanied by interest on the amount prepaid to and
80 including the date of maturity of the installment next falling due.

81 Any installment that is not paid when due is therefore delinquent. Thereafter,
82 such delinquent installment shall be subject, at the time of delinquency, to a charge of ten
83 percent penalty levied on both principal and interest due upon that installment, and all
84 delinquent installments also shall be charged interest at the rate as determined above.

85 The collection of such delinquent installments shall be enforced in the manner provided
86 by law. The amount of the final assessment, together with interest and provisions for
87 penalty, shall, upon confirmation of the assessment roll by the council, become a lien
88 upon each lot or building site within RID 133 from the time the assessment roll is placed
89 in the hands of the finance and business operations, treasury operations, for collection.

90 SECTION 5. The council, sitting as a board of equalization and having made all
91 revisions to the assessment roll it deems necessary, hereby finds that the assessment roll
92 for RID 133 is just and equitable and that no assessment against any property within RID
93 133 is greater than the special benefits to be derived from the improvement made to such
94 property. Accordingly, the assessment roll, totaling \$461,066.94, is hereby confirmed
95 and the assessments set forth therein are hereby levied against each parcel of property
96 described in the roll.

97 SECTION 6. The manager of the road services division, department of
98 transportation is hereby authorized and directed to contract with the necessary parties for
99 the design and construction of the project.

100 SECTION 7. The clerk of the council is hereby directed to place said RID 133
101 assessment roll, bearing such revisions as the council has made thereto, in the hands of
102 the King County finance and business operations for collection. Upon such placement,
103 the amount of each assessment set forth therein, together with any interest accrued from
104 time to time thereon and any penalty imposed from time to time thereon, will become a
105 lien against the property so assessed. The lien shall be paramount and superior to any
106 other lien or encumbrance whatsoever, theretofore and thereafter created, except for a
107 lien for general taxes.

108 SECTION 8. There is hereby created on the books of the King County finance
109 and business operations one fund of the county, to be designated as the "King County
110 Road Improvement District No. 133 enhanced RID (ERID) fund."
111 Upon receipt of the RID 133 assessment roll, the King County finance and business
112 operations is hereby directed to publish notice at the times and in the manner required by
113 RCW 36.88.270, stating that such assessments or any portion thereof may be paid
114 without interest in the days following first publication of such notice. All moneys
115 collected by the finance and business operations upon any assessment levied on property
116 within RID 133 for the completion of the project during the thirty-day period allowed for
117 payment of such assessment without penalty or interest and all such moneys collected
118 thereafter shall be placed in the said ERID fund. The ERID fund shall be used for the
119 payment of costs and expenses of accomplishing the project and the payment of the
120 principal or interest on the balance drawn upon or issued against the loan. Moneys in
121 said ERID fund shall be used solely to pay principal, and interest on the loan. Upon
122 repayment of the loan, the balance of the RID 133 ERID fund shall be placed in the King
123 County RID/LID participation fund 0386 "Project - RDCW15."

124 SECTION 9. "Costs and expenses of accomplishing the project," as used in this
125 ordinance and in any subsequent ordinance relating to RID 133, shall mean those costs
126 and expenses described in RCW 36.88.300, as follows:

127 A. The cost of all of the construction or improvement authorized in RID 133,
128 including that portion of the construction or improvement within the limits of any street
129 or road intersection, space, or spaces;

130 B. The costs and expense of all engineering and surveying necessary to be done
131 by the county engineer or under his direction or by such other engineer as may be
132 employed by the King County council; and

133 C. The cost of legal service and any other expense incurred by King County for
134 RID 133 or in the formation thereof, or by said district in connection with such

135 construction of improvement and in the financing thereof, including the issuance of
136 interim financing and long-term financing.

137

Ordinance 15058 was introduced on 8/30/2004 and passed as amended by the Metropolitan King County Council on 11/8/2004, by the following vote:

Yes: 11 - Mr. Phillips, Ms. Edmonds, Mr. von Reichbauer, Ms. Lambert, Mr. Pelz, Mr. Ferguson, Mr. Gossett, Ms. Hague, Mr. Irons, Ms. Patterson and Mr. Constantine
No: 0
Excused: 2 - Mr. McKenna and Mr. Hammond

KING COUNTY COUNCIL
KING COUNTY, WASHINGTON

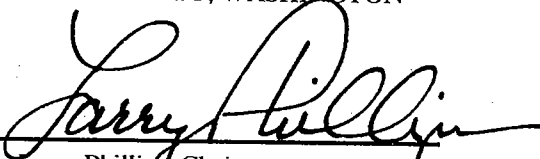
Larry Phillips, Chair

ATTEST:

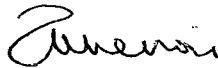

Anne Noris, Clerk of the Council

RECEIVED
2004 NOV 19 PM 1:54
KING COUNTY COUNCIL
CLERK

APPROVED this 19 day of November, 2004.

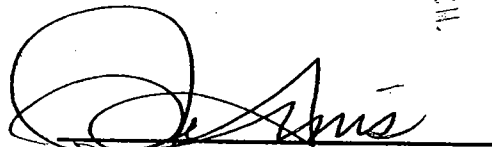
Ron Sims, County Executive

Attachments A. Proposed RID for NE 52nd Street Map, B. Assessment Roll - King County Road Improvement District 133 - Northeast 52nd Street (Ames Lake Carnation Road to 298th Avenue Northeast) dated 11/8/04

ATTACHMENT A

15058

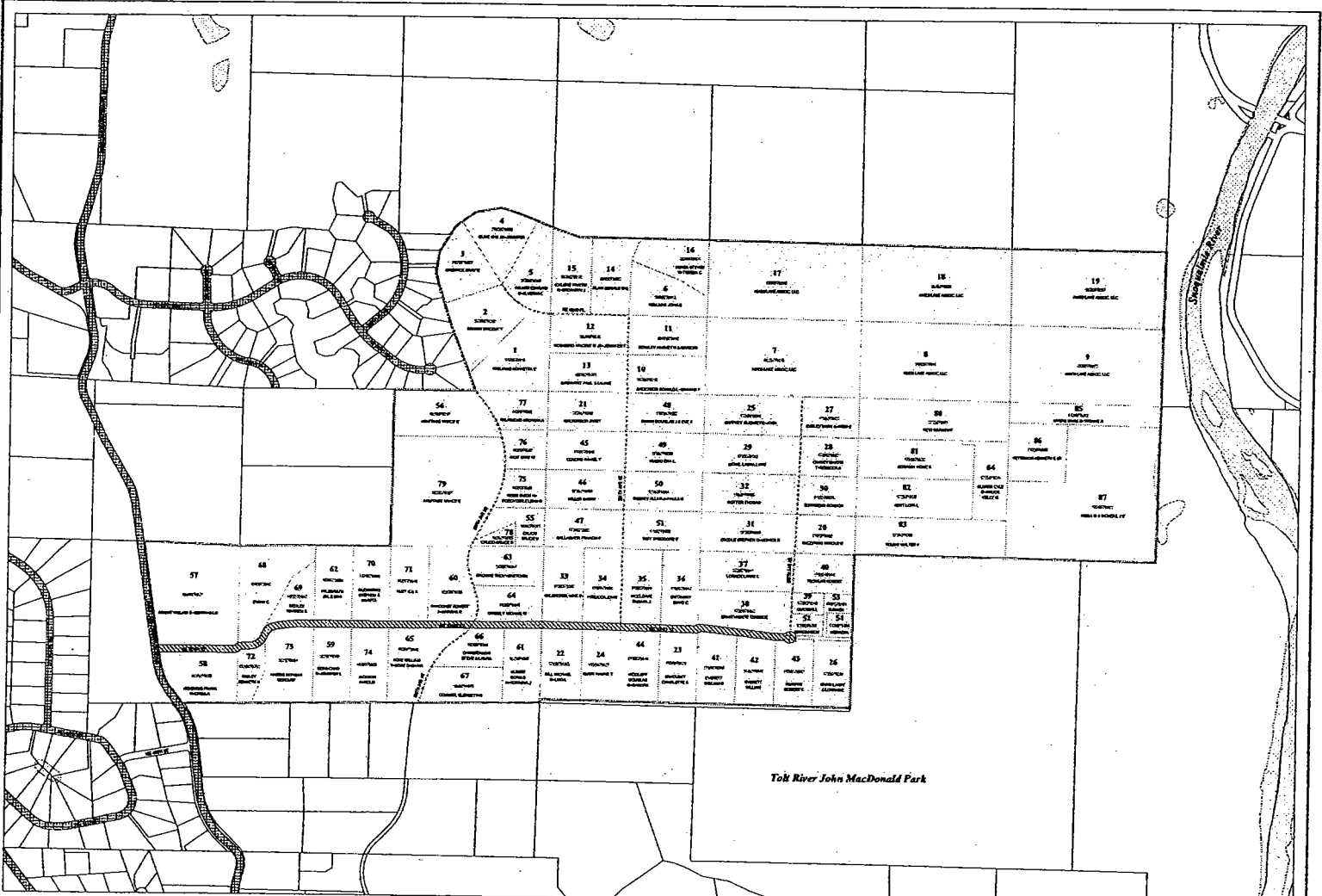

Proposed RID

For NE 52nd Street

- RID Assessment Area
- Improvement Area
- Existing Maintained Roads
- Private Road Easements
- Water Area
- Parks
- Parcels proposed to be assessed \$ 5,299.62 each
- Incorporated Area



King County

The information shown on this map has been compiled by King County and is intended for informational purposes only. King County does not warrant the accuracy, completeness, or timeliness of the information shown on this map. King County is not responsible for any errors or omissions on this map. King County is not responsible for any damages, including consequential damages, arising from the use of this map. King County is not responsible for any actions taken based on the information shown on this map. King County is not responsible for any actions taken based on the information shown on this map.



ATTACHMENT "B"
 ASSESSMENT ROLL - KING COUNTY ROAD IMPROVEMENT DISTRICT 133
 Northeast 52nd Street (Ames Lake Carnation Road to 298th Avenue Northeast) 11/8/04

Parcel No.	Name of Owner	Legal Description	Assessment
1	0725079016-00 Noretta Williams 10201 NE 23 St Bellevue, WA 98004	LOT C-1 OF KC SHORT PLAT NO 977007 REC NO 7712270467 SD PLAT DAF - POR OF NE 1/4 OF SE 1/4 SEC 07 TWP 25 RNG 7 LY S & E OF C/L OF ABANDONED RR GRADE AS WAS ON 6/26/44 TGW POR OF SE 1/4 OF SE 1/4 LY ELY OF SD RR GRADE C/L	\$5,361.24
2	0725079039-03 Vincent Brown 29127 NE 62 Pl Carnation, WA 98014	LOT D-1 KC SHORT PLAT #178050 REC AF #7909280988 SD SHORT PLAT DAF THAT POR OF THE SE 1/4 SEC 7 TWP 25 RNG 7 KNOWN AS LOT C-2 OF SHORT PLAT #977007 AS FILED UNDER RECORDING NUMBER 7712270467 SUBJ TO RESERVATIONS & ESMTS OF RECORD	\$5,361.24
3	0725079057-00 Gary Breiwick 29105 NE 62 Pl Carnation, WA 98014	LOT D-2 KC SHORT PLAT # 178050 REC AF #7909280988 SD SHORT PLAT DAF THAT POR OF THE SE 1/4 SEC 7 TWP 25 RNG 7 KNOWN AS LOT C-2 OF SHORT PLAT #977007 AS FILED UNDER RECORDING NUMBER 7712270467 SUBJ TO RESERVATIONS & ESMTS OF RECORD	\$5,361.24
4	0725079058-09 M. Jr & Jennifer Cline 29104 NE 62 Pl Carnation, WA 98014	LOT D-3 KC SHORT PLAT #178050 REC AF #7909280988 SD SHORT PLAT DAF THAT POR OF THE SE 1/4 SEC 7 TWP 25 RNG 7 KNOWN AS LOT C-2 OF SHORT PLAT #977007 AS FILED UNDER RECORDING NUMBER 7712270467 SUBJ TO RESERVATIONS & ESMTS OF RECORD	\$5,361.24
5	0725079059-08 Edmund & Alverna Palmer 29138 NE 62 Pl Carnation, WA 98014	LOT D-4 KC SHORT PLAT #178050 REC AF #7909280988 SD SHORT LAT DAF THAT POR OF THE SE 1/4 SEC 7 TWP 25 RNG 7 KNOWN AS LOT C-2 OF SHORT PLAT #977007 AS FILED UNDER RECORDING NUMBER 7712270467 SUBJ TO RESERVATIONS & ESMTS OF RECORD	\$5,361.24
6	0825079012-03 John Hellman 6200 - 294 Ave NE Carnation, WA 98014	LOT B-1 KC SHORT PLAT #677042 REC UNDER AF #7904060819 SD SHORT PLAT DAF THE N 1/2 OF SW 1/4 OF SW 1/4 SEC 8 TWP 25 RNG 7 TGW THAT POR OF NW 1/4 OF SW 1/4 SEC 8 TWP 25 RNG 7 BEG AT SW COR SD SUBD TH NLY ALG W LN SD SUBD 81.78 FT TH SELY 229.55 FT M/L TAP WCH IS ON S LN OF SD SUBD & 214.55 FT E OF SW COR THOF TH WLY ALG SD S LN 214.55 FT TO POB SUBJ TO RESERVATION OF C/M RGTS & ESMTS OF RECORD	\$5,361.24
7	0825079013-02 Ames Lake Associates, LLC 18306 Driftwood Drive E. Sumner, WA 98390	S 1/2 OF SE 1/4 OF SW 1/4 SEC 08 TWP 25 RNG 7 THIS PARCEL DESIGNATED FOREST LAND PURSUANT TO SUBSECTION (3) OF RCW 84.33.120 OF 84.33.130	\$5,361.24

Parcel No.	Name of Owner	Legal Description	Assessment
8	0825079016-09 Ames Lake Associates, LLC 18306 Driftwood Drive E. Sumner, WA 98390	S 1/2 OF SW 1/4 OF SE 1/4 SEC 08 TWP 25 RNG 7 THIS PARCEL DESIGNATED FOREST LAND PURSUANT TO SUBSECTION (3) OF RCW 84.33.120 OR 84.33.130	\$5,361.24
9	0825079017-08 Ames Lake Associates, LLC 18306 Driftwood Drive E. Sumner, WA 98390	S 1/2 OF SE 1/4 OF SE 1/4 SEC 08 TWP 25 RNG 7 THIS PARCEL DESIGNATED FOREST LAND PURSUANT TO SUBSECTION (3) OF RCW 84.33.120 OR 84.33.130	\$5,361.24
10	0825079018-07 Donald & Graham Anderson 6016 - 294 Ave NE Carnation, WA 98014	LOT A-1 KC SP 677041 REC AF # 7809130795 SD SP DAF S 1/2 OF SW 1/4 OF SW 1/4 SEC 08 TWP 25 RNG 7	\$5,361.24
11	0825079019-06 Harvey & Marilyn Stanley 6120 - 294 Ave NE Carnation, WA 98014	LOT A-2 KC SP 677041 REC AF # 7809130795 SD SP DAF S 1/2 OF SW 1/4 OF SW 1/4 SEC 08 TWP 25 RNG 7	\$5,361.24
12	0825079020-03 Vincent & Jennifer Roggero 29325 NE 62 PI Carnation, WA 98014	LOT A-3 KC SP 677041 REC AF # 7809130795 SD SP DAF S 1/2 OF SW 1/4 OF SW 1/4 SEC 08 TWP 25 RNG 7	\$5,361.24
13	0825079021-02 Paul & Laurie Barnhart 6017 - 294 Ave NE Carnation, WA 98014	LOT A-4 KC SP 677041 REC AF # 7809130795 SD SP DAF S 1/2 OF SW 1/4 OF SW 1/4 SEC 08 TWP 25 RNG 7	\$5,361.24
14	0825079022-01 Don Blair & Kathleen Bemis 29320 NE 62 PI Carnation, WA 98014	LOT B-2 KC SHORT PLAT #677042 REC UNDER AF #7904060819 SD SHORT PLAT DAF THE N 1/2 OF SW 1/4 OF SW 1/4 SEC 8 TWP 25 RNG 7 TGW THAT POR OF NW 1/4 OF SW 1/4 SEC 8 TWP 25 RNG 7 BEG AT SW COR SD SUBD TH NLY ALG W LN SD SUBD 81.78 FT TH SELY 229.55 FT M/L TAP WCH IS ON S LN OF SD SUBD & 214.55 FT E OF SW COR THOF TH WLY ALG SD S LN 214.55 FT TPOB SUBJ TO RESERVATION OF C/M RGTS & ESMTS OF RECORD	\$5,361.24
15	0825079023-00 Martin & Bronwyn Calsyn 29210 NE 62 St Carnation, WA 98014	LOT B-3 KC SHORT PLAT #677042 REC UNDER AF #7904060819 SD SHORT PLAT DAF THE N 1/2 OF SW 1/4 OF SW 1/4 SEC 8 TWP 25 RNG 7 TGW THAT POR OF NW 1/4 OF SW 1/4 SEC 8 TWP 25 RNG 5 BEG AT SW COR SD SUBD TH NLY ALG W LN SD SUBD 81.78 FT TH SELY 229.55 FT M/L TAP WCH IS ON S LN OF SD SUBD & 214.55 FT E OF SW COR THOF TH WLY ALG SD S LN 214.55 FT TPOB SUBJ TO RESERVATION OF C/M RGTS & ESMTS OF RECORD	\$5,361.24

ATTACHMENT "B"
 ASSESSMENT ROLL - KING COUNTY ROAD IMPROVEMENT DISTRICT 133
 Northeast 52nd Street (Ames Lake Carnation Road to 298th Avenue Northeast) 11/8/04

Parcel No.	Name of Owner	Legal Description	Assessment
16	0825079024-09 Steven & Teresa Oshea 29414 NE 64 th Way Carnation, WA 98014	LOT B-4 KC SHORT PLAT #677042 REC UNDER AF #7904060819 SD SHORT PLAT DAF THE N 1/2 OF SW 1/4 OF SW 1/4 SEC 8 TWP 25 RNG 7 TGW THAT POR OF NW 1/4 OF SW 1/4 SEC 8 TWP 25 RNG 7 BEG AT SW COR SD SUBD TH NLY ALG W LN SD SUBD 81.78 FT TH SELY 229.55 FT M/L TAP WCH IS ON S LN SD SUBD & 214.55 FT E OF SW COR THOF TH WLY ALG SD S LN 214.55 FT TPOB SUBJ TO RESERVATION OF C/M RGTS & ESMTS OF RECORD	\$5,361.24
17	0825079025-08 Ames Lake Associates, LLC 18306 Driftwood Drive E. Sumner, WA 98390	N 1/2 OF SE 1/4 OF SW 1/4 SEC 08 TWP 25 RNG 7 THIS PARCEL DESIGNATED FOREST LAND PURSUANT TO SUBSECTION (3) OF RCW 84.33.120 OF 84.33.130	\$5,361.24
18	0825079026-07 Ames Lake Associates, LLC 18306 Driftwood Drive E. Sumner, WA 98390	N 1/2 OF SW 1/4 OF SE 1/4 SEC 08 TWP 25 RNG 7 THIS PARCEL DESIGNATED FOREST LAND PURSUANT TO SUBSECTION (3) OF RCW 84.33.120 OR 84.33.130	\$5,361.24
19	0825079027-06 Ames Lake Associates, LLC 18306 Driftwood Drive E. Sumner, WA 98390	N 1/2 OF SE 1/4 OF SE 1/4 SEC 08 TWP 25 RNG 7 THIS PARCEL DESIGNATED FOREST LAND PURSUANT TO SUBSECTION (3) OF RCW 84.33.120 OR 84.33.130	\$5,361.24
20	1725079005-01 Harold Raczynski 5522 - 298 Ave NE Carnation, WA 98014	LOT 3 KC SHORT PLAT NO 476100 REC NO 7703010796 SD PLAT DAF S 1/2 OF NE 1/4 OF NW 1/4 SEC 17 TWP 25 RNG 7	\$5,361.24
21	1725079006-00 Janet Halvorson P.O. Box 561 Carnation, WA 98014	LOT 1 KC SHORT PLAT #876045 AF #7806130635 SD SHORT PLAT DAF W 1/2 OF NW 1/4 OF NW 1/4 SEC 17 TWP 25 RNG 7	\$5,361.24
22	1725079025-07 Michael & Linda Dill 29207 NE 52 St Carnation, WA 98014	PARCEL 1 KC SHORT PLAT NO 176020 REC NO 7704150929 SD PLAT DAF - S 1/2 OF SW 1/4 OF NW 1/4 SEC 17 TWP 25 RNG 7 LESS S 30 FT THOF	\$5,361.24
23	1725079026-06 Charlotte Sandusky 4415 NE 60 St Seattle, WA 98115	PARCEL 4 KC SHORT PLAT NO 176020 REC NO 7704150929 SD PLAT DAF - S 1/2 OF SW 1/4 OF NW 1/4 SEC 17 TWP 25 RNG 7 LESS S 30 FT THOF	\$5,361.24
24	1725079027-05 Wayne Rubin 29335 NE 52nd Street Carnation, WA 98014	PARCEL 2 KC SHORT PLAT NO 176020 REC NO 7704150929 SD PLAT DAF - S 1/2 OF SW 1/4 OF NW 1/4 SEC 17 TWP 25 RNG 7 LESS S 30 FT THOF	\$5,361.24
25	1725079028-04 John & Elizabeth Gaffney 5909 - 298 Ave NE Carnation, WA 98014	PP ACT 39905633 MOBILE HOME LOT 1 KC SHORT PLAT NO 476101 REC NO 7703010797 SD PLAT DAF N 1/2 OF NE 1/4 OF NW 1/4 SEC 17 TWP 25 RNG 7	\$5,361.24

Parcel No.	Name of Owner	Legal Description	Assessment
26	1725079029-03 Larry & Lorraine Kapin 29901 NE 52 St Carnation, WA 98014	PARCEL 4 KC SHORT PLAT NO 576046 REC #7704281053 SD SP DAF POR OF SE 1/4 OF NW 1/4 SEC 17 TWP 25 RNG 7 LY SLY OF NLY LN 60 FT RD ESMT REC NO 7603120429 LESS S 30 FT THOF	\$5,361.24
27	1725079031-09 Mark & Heidi Ensley 5902 - 298 Ave NE Carnation, WA 98014	PP ACT 39926175 MOBILE HOME LOT 2 KC SHORT PLAT NO 476101 REC NO 7703010797 SD PLAT DAF N 1/2 OF NE 1/4 OF NW 1/4 SEC 17 TWP 25 RNG 7	\$5,361.24
28	1725079032-08 Martin & Rebecca Chaney 5802 - 298 Ave NE Carnation, WA 98014	LOT 3 KC SHORT PLAT NO 476101 REC NO 7703010797 SD PLAT DAF N 1/2 OF NE 1/4 OF NW 1/4 SEC 17 TWP 25 RNG 7	\$5,361.24
29	1725079033-07 Laura Stahl 5801 - 298 Ave NE Carnation, WA 98014	LOT 4 KC SHORT PLAT NO 476101 REC NO 7703010797 SD PLAT DAF N 1/2 OF NE 1/4 OF NW 1/4 SEC 17 TWP 25 RNG 7	\$5,361.24
30	1725079034-06 Gordon Townsend 5616 - 298 Ave NE Carnation, WA 98014	LOT 2 KC SHORT PLAT NO 476100 REC NO 7703010796 SD PLAT DAF S 1/2 OF NE 1/4 OF NW 1/4 SEC 17 TWP 25 RNG 7	\$5,361.24
31	1725079035-05 Stephen & Monica Crodle 5511 - 298 Ave NE Carnation, WA 98014	PP ACT 38346193 MOBILE HOME LOT 4 KC SHORT PLAT NO 476100 REC NO 7703010796 SD PLAT DAF S 1/2 OF NE 1/4 OF NW 1/4 SEC 17 TWP 25 RNG 7	\$5,361.24
32	1725079036-04 Thomas Rotter 5615 - 298 Ave NE Carnation, WA 98014	PP ACT 39926183 MOBILE HOME LOT 1 KC SHORT PLAT NO 476100 REC NO 7703010796 SD PLAT DAF S 1/2 OF NE 1/4 OF NW 1/4 SEC 17 TWP 25 RNG 7	\$5,361.24
33	1725079037-03 Kirk & Nancy Kalbrener 29216 NE 52 St Carnation, WA 98014	LOT 1 KC SHORT PLAT NO 576009 REC NO 7704150928 SD PLAT DAF - N 1/2 OF SW 1/4 OF NW 1/4 SEC 17 TWP 25 RNG 7	\$5,361.24
34	1725079038-02 John Perucca 13408 Graywolf PI NE Poulsbo, WA 98370	LOT 2 KC SHORT PLAT NO 576009 REC NO 7704150928 SD PLAT DAF - N 1/2 OF SW 1/4 OF NW 1/4 SEC 17 TWP 25 RNG 7	\$5,361.24
35	1725079039-01 Tamara McCleave 5218 - 294 Ave NE Carnation, WA 98014	LOT 3 KC SHORT PLAT NO 576009 REC NO 7704150928 SD PLAT DAF - N 1/2 OF SW 1/4 OF NW 1/4 SEC 17 TWP 25 RNG 7	\$5,361.24
36	1725079040-08 David Svitavsky 29504 NE 52 St Carnation, WA 98014	LOT 4 KC SHORT PLAT NO 576009 REC NO 7704150928 SD PLAT DAF - N 1/2 OF SW 1/4 OF NW 1/4 SEC 17 TWP 25 RNG 7	\$5,361.24
37	1725079041-07 Larry Lorack 5409 - 298 Ave NE Carnation, WA 98014	PARCEL 1 KC SHORT PLAT NO 576045 REC NO 7704150927 SD PLAT DAF- POR OF SE 1/4 OF NW 1/4 SEC 17 TWP 25 RNG 7 LY NLY OF 60 FT RD ESMT REC NO 7603120429	\$5,361.24

ATTACHMENT "B"
 ASSESSMENT ROLL - KING COUNTY ROAD IMPROVEMENT DISTRICT 133
 Northeast 52nd Street (Ames Lake Carnation Road to 298th Avenue Northeast) 11/8/04

Parcel No.	Name of Owner	Legal Description	Assessment
38	1725079042-06 Terence Branthwaite 5225 - 298 Ave NE Carnation, WA 98014	PARCEL 2 KC SHORT PLAT NO 576045 REC NO 7704150927 SD PLAT DAF-POR OF SE 1/4 OF NW 1/4 SEC 17 TWP 25 RNG 7 LY NLY OF L0 FT RD ESMT REC NO 7603120429	\$5,361.24
39	1725079043-05 John & Colleen Quicksall 5230 - 298 Ave NE Carnation, WA 98014	LOT 1 KCSP #185001 REC #8903299001 SD SP DAF LOT 3 KCSP #576045 REC #7704150927 BEING A POR OF SE 1/4 OF NW 1/4 SEC 17 TWP 25 RNG 7 LY N OF EXISTING RD ESMT	\$5,361.24
40	1725079044-04 Robert Tschilar 5400 - 298 Ave NE Carnation, WA 98014	PP ACT 39926191 MOBILE HOME PARCEL 4 KC SHORT PLAT NO 576045 REC NO 7704150927 SD PLAT DAF-POR OF SE 1/4 OF NW 1/4 SEC 17 TWP 25 RNG 7 LY NLY OF 60 FT RD ESMT REC NO 7603120429	\$5,361.24
41	1725079045-03 William Everett P.O. Box 3487 Redmond, WA 98073	PARCEL 1 KC SHORT PLAT NO 576046 REC NO 7704281053 SD PLAT DAF-POR OF SE 1/4 OF NW 1/4 SEC 17 TWP 25 RNG 7 LY SLY OF NLY LN 60 FT RD ESMT REC NO 7603120429 LESS S 30 FT THOF	\$5,361.24
42	1725079046-02 William Everett P.O. Box 3487 Redmond, WA 98073	PARCEL 2 KC SHORT PLAT NO 576046 REC NO 7704281053 SD PLAT DAF POR OF SE 1/4 OF NW 1/4 SEC 17 TWP 25 RNG 7 LY SLY OF NLY LN 60 FT RD ESMT REC NO 7603120429 LESS S 30 FT THOF	\$5,361.24
43	1725079047-01 Robert Murphy 29803 NE 52 St Carnation, WA 98014	PARCEL 3 KC SHORT PLAT NO 576046 REC NO 7704281053 SD PLAT DAF POR OF SE 1/4 OF NW 1/4 SEC 17 TWP 25 RNG 7 LY SLY OF NLY LN 60 FT RD ESMT REC NO 7603120429 LESS S 30 FT THOF	\$5,361.24
44	1725079048-00 Douglas & Sandra Heidloff 980 SW 167 PI Beaverton, OR 97006	PARCEL 3 KC SHORT PLAT NO 176020 REC NO 7704150929 SD PLAT DAF - S 1/2 OF SW 1/4 OF NW 1/4 SEC 17 TWP 25 RNG 7 LESS S 30 FT THOF	\$5,361.24
45	1725079049-09 Daniel Collins 5815 - 294 Ave NE Carnation, WA 98014	PP ACT 39926217 MOBILE HOME LOT 2 KC SHORT PLAT #876045 AF #7806130635 SD SHORT PLAT DAF W 1/2 OF NW 1/4 OF NW 1/4 SEC 17 TWP 25 RNG 7	\$5,361.24
46	1725079050-05 Danny Miller 5623 - 294 Ave NE Carnation, WA 98014	LOT 3 KC SHORT PLAT #876045 AF #7806130635 SD SHORT PLAT DAF W 1/2 OF NW 1/4 OF NW 1/4 SEC 17 TWP 25 RNG 7	\$5,361.24
47	1725079051-04 Francis Gallagher 5603 - 294 Ave NE Carnation, WA 98014	LOT 4 KING CO SHORT PLAT NO 876045 RECORDING NO 7806130635 BEING A PORTION OF NW 1/4 NW 1/4 STR SEC 17 TWP 25 RNG 7	\$5,361.24
48	1725079052-03 Douglas & Eve Dakan 5918 - 294 Ave NE Carnation, WA 98014	LOT 1 KC SHORT PLAT #876046 AF #7806130636 SD SHORT PLAT DAF E 1/2 OF NW 1/4 OF NW 1/4 OF SEC 17 TWP 25 RNG 7	\$5,361.24
49	1725079053-02 Ena Russo 6034 - 142 Ct NE Redmond, WA 98052	LOT 2 KC SHORT PLAT #876046 AF #7806130636 SD SHORT PLAT DAF E 1/2 OF NW 1/4 OF NW 1/4 OF SEC 17 TWP 25 RNG 7	\$5,361.24

Parcel No.	Name of Owner	Legal Description	Assessment
50	1725079054-01 Allan & Paula Beeney 5612- 294 Ave NE Carnation, WA. 98014	LOT 3 KC SHORT PLAT #876046 AF #7806130636 SD SHORT PLAT DAF E 1/2 OF NW 1/4 OF NW 1/4 OF SEC 17 TWP 25 RNG 7	\$5,361.24
51	1725079055-00 Theodore Taft 11135 - 157 Ave NE Redmond, WA 98052	LOT 4 KC SHORT PLAT #876046 AF #7806130636 SD SHORT PLAT DAF E 1/2 OF NW 1/4 OF NW 1/4 OF SEC 17 TWP 25 RNG 7	\$5,361.24
52	1725079060-03 Peter Emhoff & Edit Marcinkech 5214- 298 Ave NE Carnation, WA 98014	LOT 2 KCSP #185001 REC #8903299001 SD SP DAF LOT 3 KCSP #576045 REC #7704150927 BEING A POR OF SE 1/4 OF NW 1/4 SEC 17 TWP 25 RNG 7 LY N OF EXISTING RD ESMT	\$5,361.24
53	1725079061-02 Michael & Sheila Turner 29904 NE 52 St Carnation, WA 98014	LOT 3 KCSP #185001 REC #8903299001 SD SP DAF LOT 3 KCSP #576045 REC #7704150927 BEING A POR OF SE 1/4 OF NW 1/4 SEC 17 TWP 25 RNG 7 LY N OF EXISTING RD ESMT	\$5,361.24
54	1725079062-01 Jesse & Frances Herrera 29908 NE 52 St Carnation, WA 98014	LOT 4 KCSP #185001 REC #8903299001 SD SP DAF LOT 3 KCSP #576045 REC #7704150927 BEING A POR OF SE 1/4 OF NW 1/4 SEC 17 TWP 25 RNG 7 LY N OF EXISTING RD ESMT	\$5,361.24
55	1825079001-04 Bruce Calico 5516 - 290 Ave NE Carnation, WA 98014	PARCEL 1 KC SHORT PLAT NO 1275044 REC NO 7604020599 SD PLAT DAF POR OF NE 1/4 OF NE 1/4 SEC 18 TWP 25 RNG 7 LY ELY OF ABANDONED LOGGING GRADE IN SD NE 1/4 OF NE 1/4 AKA PRESENT EXISTING 60 FT ESMT RD LESS POR SD PARCEL 1 DAF BEG SE COR OF NE 1/4 OF NE 1/4 TH S 87-58-26 W ALG S LN THOF 252.95 FT TO TPOB TH CONT S 87-58-26 W 375.50 FT TO C/L ABANDONED LOGGING GRADE TH NLY ALG SD C/L 50 FT TH NELY TAP WCH BEARS N 0-59-36 W 200 FT FR TPOB TH S 0-59-36 E 200 FT TO TPOB	\$5,361.24
56	1825079017-06 Nancy Armitage 5821 - 290 Ave NE Carnation, WA 98014	THAT POR OF NE 1/4 OF NE 1/4 SEC 18-25-7-BEG NW COR SD SUBD TH SLY ALG W LN THOF DIST 400 FT TH ELY TO C/L ABANDONED RR GRADE TH NWLY ALG SD RR R/W TO N LN SD SUBD TH WLY ALG SD N LN DIST 680.38 FT TO POB -TAXABLE PORTION PARTIALLY EXEMPT UNDER RCW 84.36.381 THRU .389	\$5,361.24
57	1825079027-04 William Bright & Lo Gehring 5701 Seaview NW Seattle, WA 98107	POR OF SE 1/4 OF NW 1/4 SEC 18 TWP 25 RNG 7 LY ELY OF CO RD LESS S 450 FT	\$5,361.24
58	1825079028-03 Frank & Linda Sebenius 5030 Ames Lake Rd Carnation, WA 98014	S 450 FT OF POR OF SE 1/4 OF NW 1/4 SEC 18 TWP 25 RNG 7 LY ELY OF AMES LAKE RD	\$5,361.24
59	1825079035-04 Chad & Jennifer Berg 28627 NE 52 St Carnation, WA 98014	PARCEL C KING CO SHORT PLAT NO 573056 REC NO 7603080520 BEING A REVISION OF REC NO 7512180489 SD SP DAF: POR OF SW QTR OF NE QTR SEC 18 TWP 25 RNG 7 LY SLY OF C/L OF RD ESMT AS DESCRIBED IN AF #7210260546	\$5,361.24

ATTACHMENT "B"
ASSESSMENT ROLL - KING COUNTY ROAD IMPROVEMENT DISTRICT 133
 Northeast 52nd Street (Ames Lake Carnation Road to 298th Avenue Northeast) 11/8/04

Parcel No.	Name of Owner	Legal Description	Assessment
60	1825079036-03 Robert & Marsha Pancoast P.O. Box 568 Carnation, WA 98014	PARCEL B KC SHORT PLAT NO 174019 REC NO 7504160610 SD PLAT DAF N 1/2 OF SE 1/4 OF NE 1/4 SEC 18 TWP 25 RNG 7	\$5,361.24
61	1825079037-02 Donald & Roxanna Hubert 29103 NE 52 St Carnation, WA 98014	TR C KC SHORT PLAT NO 374004 REC NO 7504220563 DAF S 1/2 OF SE 1/4 OF NE 1/4 SEC 18 TWP 25 RNG 7	\$5,361.24
62	1825079038-01 Dan & Jill Pflugrath 28614 NE 52 St Carnation, WA 98014	PARCEL C KC SHORT PLAT NO 1173004 REC NO 7512180488 DAF POR OF SW 1/4 OF NE 1/4 SEC 18 TWP 25 RNG 7 LY NLY OF C/L OF RD ESMT AF 7210260546	\$5,361.24
63	1825079041-06 Troy & Gretchen Browne 5402 - 290 Ave NE Carnation, WA 98014	PARCEL C OF KC SHORT PLAT NO 174019 REC NO 7504160610 SD PLAT DAF N 1/2 OF SE 1/4 OF NE 1/4 SEC 18 TWP 25 RNG 7	\$5,361.24
64	1825079042-05 Michael O'Reilly 3052 231 st Ln SE. Apt C202 Sammamish, WA 98075	PARCEL D OF KC SHORT PLAT NO 174019 REC NO 7504160610 SD PLAT DAF N 1/2 OF SE 1/4 OF NE 1/4 SEC 18 TWP 25 RNG 7	\$5,361.24
65	1825079043-04 William & Dagmar Sode 1805 - 134 Ave SE, #10 Bellevue, WA 98005	TR A KC SHORT PLAT NO 374004 REC NO 7504220563 DAF S 1/2 OF SE 1/4 OF NE 1/4 SEC 18 TWP 25 RNG 7	\$5,361.24
66	1825079044-03 Steve & Laura Christenson 29021 NE 52 St Carnation, WA 98014	PP ACT 39926894 MOBILE HOME TR B KC SHORT PLAT NO 374004 REC NO 7504220563 DAF S 1/2 OF SE 1/4 OF NE 1/4 SEC 18 TWP 25 RNG 7	\$5,361.24
67	1825079045-02 Elizabeth Connell 5020 - 290 Ave NE Carnation, WA 98014	TR D KC SP #374004 REC #7504220563 SD SP DAF S 1/2 OF SE 1/4 OF NE 1/4 SEC 18-25-7	\$5,361.24
68	1825079046-01 C Evans 1354 P.O. Box 257 Olympia, WA 98507	PARCEL A KC SHORT PLAT NO 1173004 REC NO 7512180488 DAF POR OF SW 1/4 OF NE 1/4 SEC 18 TWP 25 RNG 7 LY NLY OF C/L OF RD ESMT AF 7210260546	\$5,361.24
69	1825079047-00 Warren Medley 28520 NE 52 St Carnation, WA 98014	PARCEL B KC SHORT PLAT NO 1173004 REC NO 7512180488 DAF POR OF SW 1/4 OF NE 1/4 SEC 18 TWP 25 RNG 7 LY NLY OF C/L OF RD ESMT AF 7210260546	\$5,361.24
70	1825079048-09 Stephen & Mareta Guerrero P.O. Box 2114 Redmond, WA 98073	PARCEL D KC SHORT PLAT NO 1173004 REC NO 7512180488 DAF POR OF SW 1/4 OF NE 1/4 SEC 18 TWP 25 RNG 7 LY NLY OF C/L RD ESMT AF 7210260546	\$5,361.24
71	1825079049-08 K & A Huet 28754 NE 52 St Carnation, WA 98014	PP ACT 37304169 MOBILE HOME PARCEL A KC SHORT PLAT NO 174019 REC NO 7504160610 SD PLAT DAF N 1/2 OF SE 1/4 OF NE 1/4 SEC 18 TWP 25 RNG 7	\$5,361.24

Parcel No.	Name of Owner	Legal Description	Assessment
72	1825079050-04 Kenneth Easley 28413 NE 52 St Carnation, WA 98014	PARCEL A KING CO SHORT PLAT NO 573056 REC NO 7603080520 BEING A REVISION OF REC NO 7512180489 SD SP DAF: POR OF SW QTR OF NE QTR SEC 18 TWP 25 RNG 7 LY SLY OF C/L OF RD ESMT AS DESCRIBED IN AF #7210260546	\$5,361.24
73	1825079051-03 Morgan Harris 28415 NE 52 St Carnation, WA 98014	PARCEL B KING CO SHORT PLAT NO 573056 REC NO 7603080520 BEING A REVISION OF REC NO 7512180489 SD SP DAF: POR OF SW QTR OF NE QTR SEC 18 TWP 25 RNG 7 LY SLY OF C/L OF RD ESMT AS DESCRIBED IN AF #7210260546	\$5,361.24
74	1825079052-02 Harold Jackson 28417 NE 52 St Carnation, WA 98014	PARCEL D KING CO SHORT PLAT NO 573056 REC NO 7603080520 BEING A REVISION OF REC NO 7512180489 SD SP DAF: POR OF SW QTR OF NE QTR SEC 18 TWP 25 RNG 7 LY SLY OF C/L OF RD ESMT AS DESCRIBED IN AF #7210260546	\$5,361.24
75	1825079056-08 John & Sandi O'Donnell 5702 - 290 Ave NE Carnation, WA 98014	PARCEL 2 KC SHORT PLAT NO 1275044 REC NO 7604020599 SD PLAT DAF POR OF NE 1/4 OF NE 1/4 SEC 18 TWP 25 RNG 7 LY ELY OF ABANDONED LOGGING GRADE IN SD NE 1/4 OF NE 1/4 AKA PRESENT EXISTING 60 FT ESMT RD	\$5,361.24
76	1825079057-07 Gary Woy P.O. Box 739 Issaquah, WA 98027	PARCEL 3 KC SHORT PLAT NO 1275044 REC NO 7604020599 SD PLAT DAF POR OF NE 1/4 OF NE 1/4 SEC 18 TWP 25 RNG 7 LY ELY OF ABANDONED LOGGING GRADE IN SD NE 1/4 OF NE 1/4 AKA PRESENT EXISTING 60 FT ESMT RD	\$5,361.24
77	1825079058-06 Georgia Thurmond 5916 - 290 Ave NE Carnation, WA 98014	PARCEL 4 KC SHORT PLAT NO 1275044 REC NO 7604020599 SD PLAT DAF POR OF NE 1/4 OF NE 1/4 SEC 18 TWP 25 RNG 7 LY ELY OF ABANDONED LOGGING GRADE IN SD NE 1/4 OF NE 1/4 AKA PRESENT EXISTING 60 FT ESMT RD	\$5,361.24
78	1825079065-07 merged with parcel 55 Bruce Calico 5516 - 290 Ave NE Carnation, WA 98014	POR OF NE 1/4 OF NE 1/4 BEG SE COR SD NE 1/4 OF NE 1/4 SEC 18 TH S 87-58-26 W ALG S LN THOF 252.95 FT TO TPOB TH CONT S 87-58-26 W 375.50 FT TO C/L ABANDONED LOGGING GRADE TH NLY ALG SD C/L 50 FT TH NELY TAP WCH BEARS N 0-59-36 W 200 FT FR TPOB TH S 0-59-36 E 200 FT TO TPOB AKA POR PAR 1 KC SHORT PLAT #1275044 REC #7604020599 SD PLAT DAF POR OF NE 1/4 OF NE 1/4 LY ELY OF ABANDONED LOGGING GRADE IN SD NE 1/4 OF NE 1/4 AKA PRESENT EXISTING 60 FT ESMT RD	0.00
79	1825079067-05 Nancy Armitage 5821 - 290 Ave NE Carnation, WA 98014	POR OF THE NE 1/4 OF NE 1/4 OF SEC 18 TWP 25 RNG 7 DAF LY WLY OF THE ABANDONED RR R/W AND SLY OF A LN DAF BEG AT NW COR OF SD SUBD TH SLY ALG THE W LN THOF A DIST OF 400 FT AND BEG OF SD LN	\$5,361.24
80	1725079021-01 Reid Warren F 2315 248th Ave SE Sammamish WA 98075	N 1/2 OF N 1/2 OF NW 1/4 OF NE 1/4 SEC 17 TWP 25 RNG 7	\$5,361.24

ATTACHMENT "B"

ASSESSMENT ROLL - KING COUNTY ROAD IMPROVEMENT DISTRICT 133

Northeast 52nd Street (Ames Lake Carnation Road to 298th Avenue Northeast) 11/8/04

Parcel No.	Name of Owner	Legal Description	Assessment
81	1725079022-00 Sodamin Heinz K Linda S Zeppa 5817 302ND Ave N E Carnation WA 98014	PARCEL 1 KC SHORT PLAT #776009 AF #7609150565 SD SHORT PLAT DAF S 1/2 OF N 1/2 & N 1/2 OF S 1/2 OF NW 1/4 OF NE 1/4 SEC 17 TWP 25 RNG 7	\$5,361.24
82	1725079020-02 Kent Lora L 5706 302ND Ave NE Carnation WA 98014	PARCEL 2 KC SHORT PLAT #776009 AF #7609150565 SD SHORT PLAT DAF S 1/2 OF N 1/2 & N 1/2 OF S 1/2 OF NW 1/4 OF NE 1/4 SEC 17 TWP 25 RNG 7	\$5,361.24
83	1725079002-04 Young Walter P 5526 302ND Ave NE Carnation WA 98014	S 1/2 OF S 1/2 OF NW 1/4 OF NE 1/4 SEC 17 TWP 25 RNG 7	\$5,361.24
84	1725079024-08 Eldred Cyle B + Mauck Kelly 5601 302ND Ave NE Carnation WA 98014	PARCEL 3 KC SHORT PLAT #776009 AF #7609150565 SD SHORT PLAT DAF S 1/2 OF N 1/2 & N 1/2 OF S 1/2 OF NW 1/4 OF NE 1/4 SEC 17 TWP 25 RNG 7	\$5,361.24
85	1725079023-09 Myers Mark B+Yvonne A 5830 302ND AV NE Carnation WA 98014	N 1/2 OF N 1/2 OF N 1/2 OF GL 1 IN NE 1/4 SEC 17 TWP 25 RNG 7	\$5,361.24
86	1725079056-09 Peterson Kenneth E SR 5820 302ND Ave NE Carnation WA 98014	LOT 2 KC SHORT PLAT #878003 RECORDED AF #7908140949 SD SHORT PLAT DAF GL 1 SEC 17 TWP 25 RNG 7 EXCEPT N 1/2 OF N 1/2 OF N 1/2 OF NE 1/4 OF NE 1/4 SD SUBD TGW ESMTS OF RECORD	\$5,361.24
87	1725079001-05 Ives A M & McNeill J E 5810 302ND Ave NE Carnation WA 98014	LOT 1 KC SHORT PLAT #878003 RECORDED AF # 7908140949 SD SHORT PLAT DAF GL 1 SEC 17 TWP 25 RNG 7 EXCEPT N 1/2 OF N 1/2 OF N 1/2 OF NE 1/4 OF NE 1/4 SD SUBD TGW ESMTS OF RECORD	\$5,361.24
	Sub Total		\$461,066.64
	Balance (King County Participation)		\$461,066.64
	TOTAL		\$922,133.28